



MS-200™ FM Installation Guide

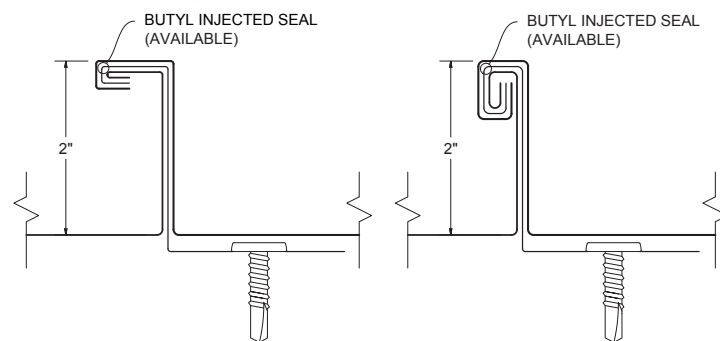



Table of Contents

Panel Specifications	2-3
FM Floating Panel Clip	4
Notes To Designer/Installer	5-7
Taylor Delivery Fleet	8
Delivery, Will Call & Loading	9
Alternate Eave – FM Clip	10
Standard Eave	11
Gutter/Hook Eave	12
Standard Ridge	13
Vented Ridge	14
End Dam Attachment	15
Valley	16
Valley – Low Slope	17
Standard Gable	18
Alternate Gable	19
Sidewall	20
Peak Flashing (R.E.C.)	21
Vented Peak Flashing (R.E.C.)	22
Pitch Change	23
Endwall	24
Vented Endwall	25
Saw Cut Endwall	26
Back Pan	27-29
Curb Sidewall	30
Curb Endwall	31
Curb Back Pan / Cricket	32
Eave to Gable Transition	33-35
Pipe Penetration – on Plate	36
Pipe Penetration – on Rib	37-38
Pipe Penetration – on Pan	39
Flashing Selection	40-43



KEY FEATURES

- 12", 14" and 16" options available
- 24 & 22 gauge Tru-Gauge™
- Floating clip system: allows for expansion/contraction of panels in longer lengths
- 2" Mechanical seam rib, 180°: Factory notching available
- Factory injected Butyl sealant
- Structural panel that will span up to 5' over open purlins
- Concealed fasteners: fasteners cannot leak
- Manufactured in Riverside CA, Sacramento CA & Salem OR
-  ICC EVALUATION SERVICE™ ICC-ESR #5046 with CBC-CRC Supplement
- FM Global Class #4471 Approved
-  - Code compliance UL Evaluation Report UL ER 25913-01
- UL Construction No. 90, 176, 180, 238, 238 A-C, 435, 435 A, 437, 449, 451, 452, 487, 506, & 506 A-C
- UL 580 Class 90 Wind Uplift, UL 790 Class A Fire rated and UL 2218 Class 4 Impact (hail) rated
- Dade PA 201-94 Class 90 Impact, 140 MPH Wind Uplift
- FM I-75 (60" o.c.)
FM I-120 (24" o.c.)
- ASTM E283 - Air infiltration (walls)
ASTM E331 - Water infiltration (walls)
ASTM E1592 - Structural uniform static air pressure
ASTM E1646 - Water infiltration (roof)
ASTM E1680 - Air infiltration (roof)
ASTM E2140 - Water test for full immersion hydrostatic roof systems
- Weather tightness warranty available
(Contact TMP representative for details)
- 1/2:12 minimum pitch recommended
(For lower pitches, please inquire)
- Standard panel lengths 5' to 60' - not notched
Standard panel lengths 1' to 60' - notched
(For longer panel lengths, please inquire)
- On-site roll forming available for long lengths
- Panel options: Striations, Accent Ribs, and Flat Pan
- Retro-fit systems available



- Prevents crowning
- No visible screws required
- Sharp, professional appearance

PANEL PROFILES

 ICC EVALUATION SERVICE™ ICC-ESR #5046

12", 14" and 16" coverage options

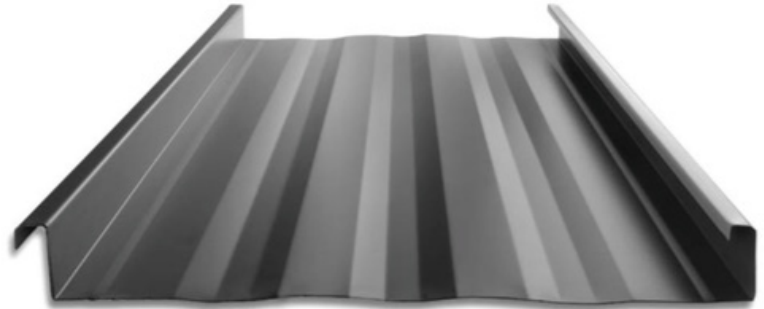

STRIATIONS

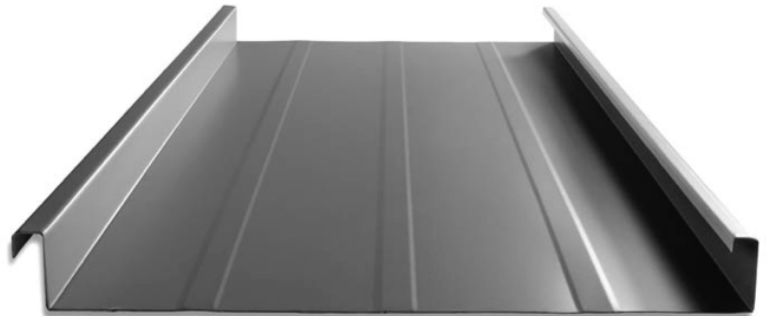

ACCENT RIBS 2 Accent ribs for 12" & 14" panels
3 Accent ribs for 16" panel

180° SEAM DETAIL

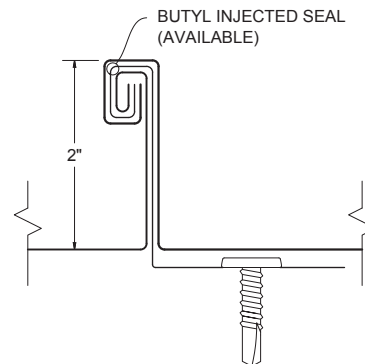

MATERIAL SPECIFICATIONS

- 24 gauge Kynar 500® Painted Steel
.0236" (Thickness prior to painting)
Galvanized G-90 or AZ-50
- 24 gauge bare Zinalume® Plus AZ-55
(No finish warranty – 25 yr. perforation warranty)
- ▲ 22 gauge Kynar 500® Painted Steel
.029" (Thickness prior to painting)
- 22 gauge Rusteel Plus™ (A606)
- Kynar 500® and substrate testing data available
(See website)
- "Oil canning" is an inherent characteristic of roof and wall products, and not a defect, which is not a cause for panel rejection

KEY FEATURES

- 21 Standard Colors, 5 Metallic Colors and 4 Specialized Colors
- Kynar 500® Paint System - the ultimate in exterior durability and color retention
- "Cool" color pigments are specially designed to reflect infrared light, reducing heat gain to dwelling, and conform with ENERGY STAR® criteria
- Superior Quality, two coat, 70% resin finish, applied at a 1 mil. thickness
- 40 year residential paint warranty
- 20 and 30 year commercial paint warranty: Contact TMP for warranty specifications

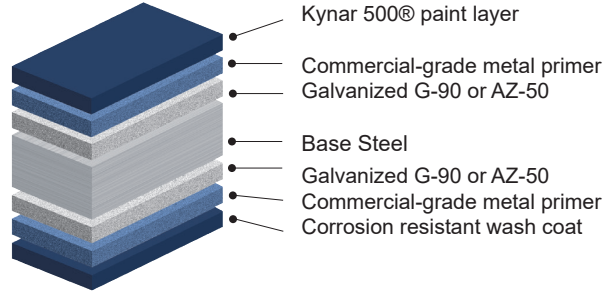

40-Year Residential / 20 and 30 Year Commercial Manufacturer's Limited Warranty

STANDARD COOL KYNAR 500® COLORS

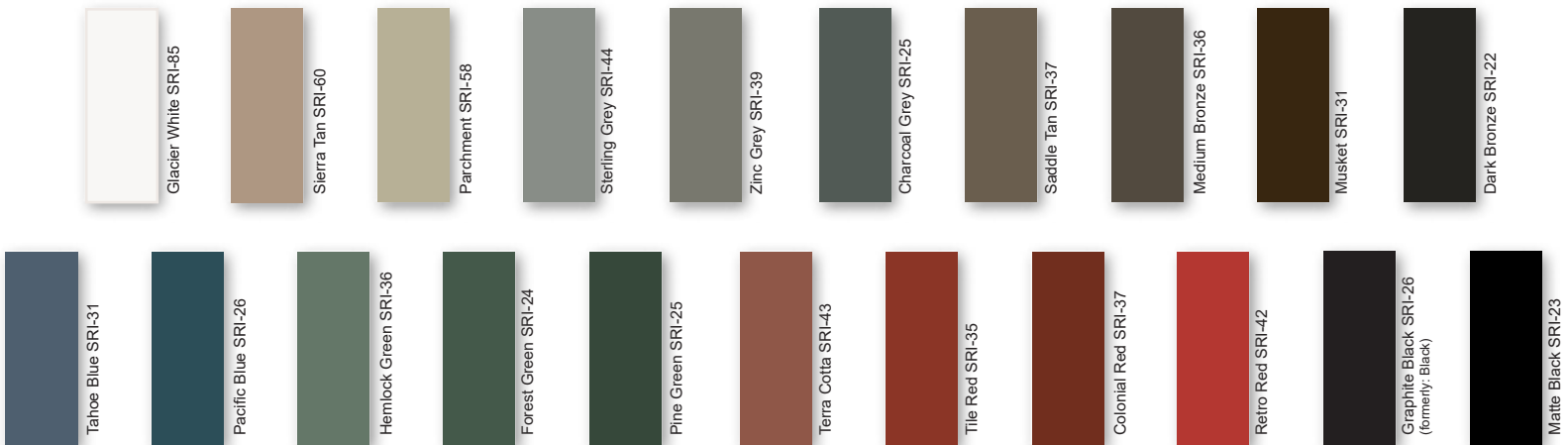

PREMIUM METALLIC COOL KYNAR® COLORS



SPECIALIZED MATERIAL

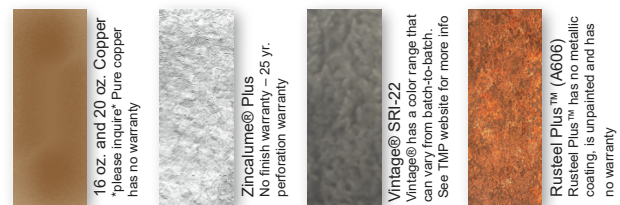

These printed chips provide a close representation of the colors.
Metal samples are available upon request. Coatings are low gloss 10-15% sheen.
SRI = Solar Reflective Index. SRI values listed above are in accordance with ASTM E 1980 and are based on actual testing. ***Oil canning is not a cause for material rejection***

Standard Panels			
Width	Gauge	LBS SQFT	LBS LF
12"	24	1.44	1.44
14"	24	1.37	1.60
16"	24	1.33	1.77
12"	22	1.74	1.74
14"	22	1.66	1.94
16"	22	1.60	2.13



**Taylor Metal Products
MS-200™ - SFS FM
Floating Panel Clip w/ injected sealant**



FM Approvals Class: 4471

Factory Mutual Rated: 1-120/1-75 A SH

1-120/1-75 (Wind Uplift), E108 A (Flame Spread) & SH (Severe Hail)

UL 580 Class 90 Wind Uplift Rated

ASTM E1592 Tested Assembly

UL Class A Fire Rated

**Clip Placement: 24" (solid deck and open purlins-120 psf) and 60"
(open purlins-75 psf) on center, per FM Testing Criteria**

Panel Widths: 12", 14" & 16" (ASTM Tested at 18")

Notes to Designer/Installer

Taylor Metal Products is providing the following details as an aid in design. The details in this guide are not inclusive to all design situations. The designer/installer is responsible for modifications and should take into consideration all aspects of the project including climate conditions, such as, snow and wind, as well as, building code requirements, building design, building usage and maintenance requirements.

Installation should be performed only by qualified installers familiar with metal roofing systems and industry standards. For details not shown in this guide, refer to the Sheet Metal and Air Conditioning Contractors National Association (SMACNA) architectural sheet metal manual for proper design. For manufacturer's weather tightness warranties – all details must be preapproved by Taylor Metal Products technical representative.

The Standard gauge for all products in this guide is 24 gauge and the standard finish is Kynar 500®. We recommend specifying all flashings be the same gauge, color, and finish as the panels to insure long-term durability and color match.

Substrates

Details in the manual are all shown over solid substrate. **MS-200™ FM** can be used over spaced purlins. For solid substrate, **Taylor Metal Products** recommends 15/32" plywood or metal decking. Contact a TMP representative with questions about panel attachment to varying substrates.

Underlayment

Minimum underlayment requirements are a synthetic underlayment with Class A and ASTM UV protection technology or TMP Protect HT self-adhering rubberized membrane. When choosing the underlayment, consider the roof slope, roof design, roof panel, and the climate.

Drag Load Requirements

All panels must be pinned at one end to resist the drag load caused by snow loads, live loads, and the weight of the panel. Drag load is a function of roof slope, actual load and length of panels. Contact **Taylor Metal Products** for specific drag load requirements.

Ventilation/Insulation

It is the responsibility of the designer to determine the material types needed to control condensation and to insulate and ventilate the roof system. Applications over rigid insulation may require blocking for solid attachment and framing the perimeter for installation of perimeter flashings.

Oil Canning

Flat metal surfaces will display waviness commonly referred to as “oil canning.” Oil canning is caused by a variety of conditions. Steel mill tolerances, variations in or uneven substrates and roofing underlayments. Oil canning is a characteristic of metal roofing, not a defect and is not a cause for rejection. **Taylor Metal Products** offers **MS-200™** with striations or accent ribs to help minimize oil canning.

Thermal Movement

The Panels and the flashings must be allowed to expand and contract, especially with longer length panels. The panel may need to have a slight gap where the panel hooks the offset cleat to allow for thermal movement of the panels.

Snow Design

The following details do not address all conditions for snow environments. Consult with the designers, engineers, and others for acceptable details to accommodate your project and climate conditions. When possible gutters, valleys, pitch changes or other penetrations should be minimized in snow areas.

All roof penetrations should be located as close to the ridge or “pin point” top of roof. Snow country requires special designs for valleys to accommodate accumulation of snow and ice from uphill panels. Roof design should be considered in snow areas. Roof design should help resist the melting and freezing of snow and ice.

A fit for purpose roof design has the greatest impact on maintaining a damage free roof system in snow areas. Please contact a Taylor Metal Products representative for assistance in detail designs and appropriate panel selection for specific climate and building conditions.

Handling / Storage & Safety

Handle materials with care when off-loading or moving materials to avoid damage to panels or flashings. Long panels may require two or more pick-up points, properly spaced to avoid damaging panels. Plan ahead; contact Taylor Metal Products for recommendations on handling/hoisting long panels.

Store the panels, flashings and accessories in a dry, well ventilated area, off the ground. If covering, allow ventilation around panels. Elevate one end of bundle to allow drainage of wet materials.

Wear clean, soft-soled shoes when walking on roofing panels to avoid damage to the painted finish.

Take care that sand, gravel, dirt, etc. sticking to your shoes is not carried onto the roof, scratching or otherwise damaging the finish on the roofing material. Walking on asphalt impregnated felt paper, especially on a hot day, can cause the asphalt to stick to your shoes and be tracked on to the roofing material.

Take care when painting to avoid getting over spray on the roofing material. Remember that wind can carry paint particles some distance. Over spray can cause the finish of the roofing material to look dull and may void your warranty.

Secure materials, especially when leaving the site, on the ground or roof to prevent winds from moving the materials. Wind-blown materials may cause damage to the material, property or persons.

Always use proper safety equipment and attire to minimize risk of cuts or other injuries.

Do not walk on panels that have not been completely installed.

Do not walk on major ribs of panels.

Metal roofs that are wet or dusty can be extremely slippery. Wear soft soled shoes and a safety harness to minimize risk of falling.

Avoid installing metal panels in windy conditions.

Safety considerations are the responsibility of the installer and his crew. Be sure to and **use common sense** generally accepted safety practices when installing roofing materials.

Taylor Delivery Fleet



Delivery Fleet

Taylor Metal Products prides itself with quick lead times delivered with our fleet of semi trucks. Our fleet of trucks are owned and operated by TMP. All of our drivers are Taylor Metal Products employees, so when your truck rolls in to deliver, you are dealing with Taylor Metal Products.

Expect consistent and exceptional service with short lead times. The inhouse fleet allows for efficient and cost-effective delivery.



Mounted on the rear of our truck's trailer, the trailer-mounted "Piggy-Back" forklift will accompany you right to your place of use, opening up unprecedented possibilities in terms of transportation. It can travel sideways, carrying panels up to 40' long, allowing delivery in locations that would typically be considered impossible to reach.

Save time and effort while avoiding potential loading and transport issues; have experienced TMP personnel deliver and unload your order.



Delivery

We will make every attempt to deliver material to the desired location. We may be unable to gain access on tight corners or steep terrain. If the site is deemed inaccessible by our driver, the customer may choose an alternate delivery site within a reasonable proximity. If we are unable to make the delivery, additional charges may be assessed.

The customer is responsible for:

- Determining adequate access for delivery ahead of time.
- Meeting the delivery at the agreed upon time.
- Providing adequate resources (1-4 people as needed) for off loading materials.
- **A charge of \$100 per hour may be added for deliveries that go beyond their allotted time**
- Checking the shipment at the time of delivery.
- Verifying material quantities against the shipping/packing list.
- Noting any damage or discrepancies upon the paper work at the time of delivery and notifying Taylor Metal Products within 48 hours of delivery.

Delivery times are usually scheduled one day in advance. Taylor Metal Products will make every effort to make the delivery at the scheduled time. Please be aware that there may be conditions beyond our control such as traffic, mechanical failures, road closures, etc. which may affect our schedule.

Will Call & Loading

Flatbed trailers and trucks are best suited to transport metal roofing materials. These can be loaded from the side with a forklift and tied down in a safe and secure manner.

We are not able to load materials onto vehicles and/or trailers which are not suitable or may be hazardous to load. Please be aware that if we find a vehicle to be inappropriate, we reserve the right to refuse to load your order.

Unacceptable examples include: boat trailers, vans, buses, motor homes, campers and box trailers. Pickup racks which do not have sufficient supports for the weight or are not long enough to support bundles are also unacceptable.

Taylor Metal Products is not responsible to tie down loads nor do we provide any tie down materials. Please bring tie downs to secure your load (string or twine are **not** acceptable for this purpose).

Consider having your order delivered on one of our trucks with a piggy back forklift.



Alternate Eave - Use With FM Clip

ALT. EAVE DETAIL

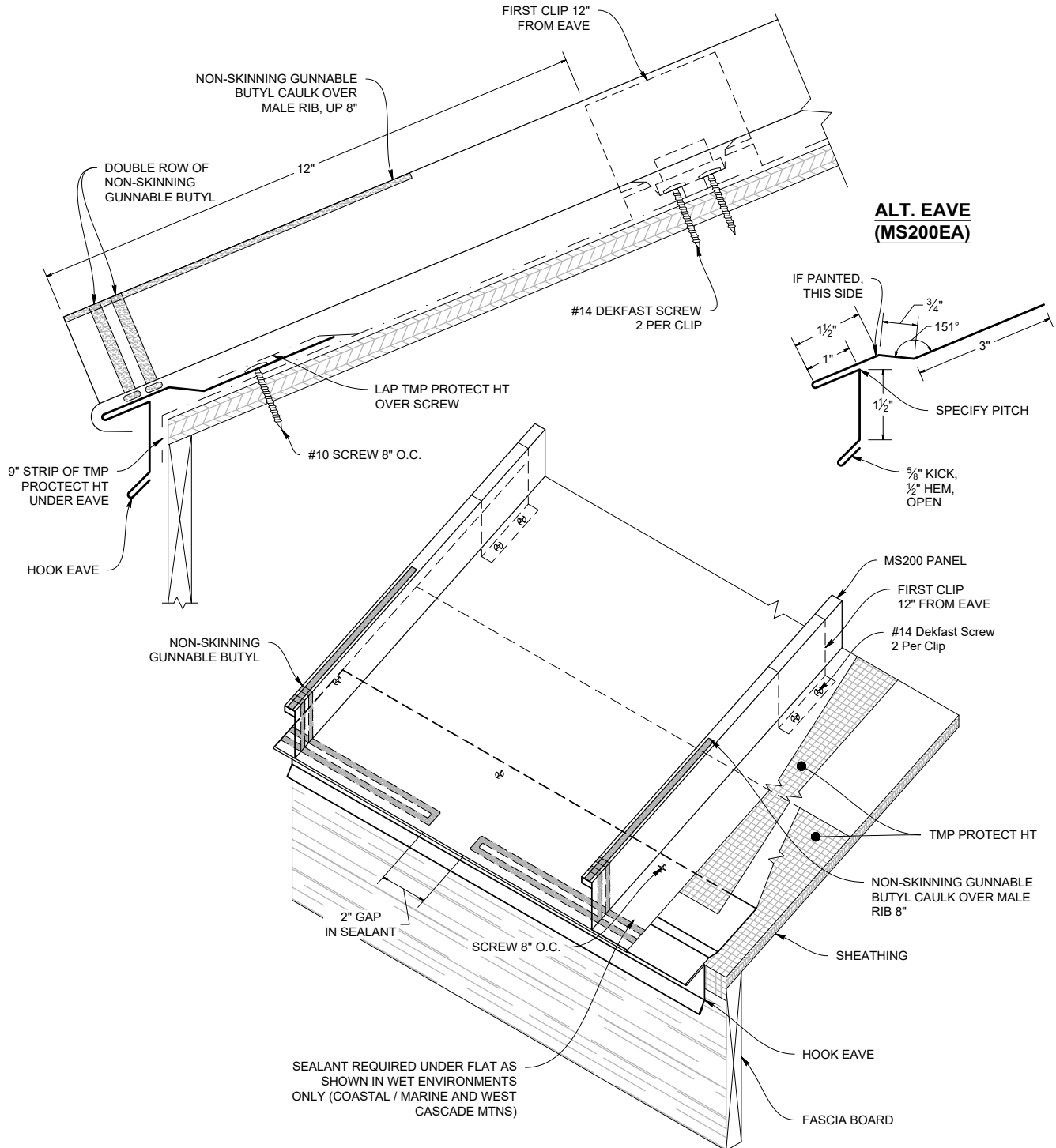

Note: All screws must be fastened into solid substrate.
Flashing must be lapped 4" with 3 rows of gunnable butyl.

STANDARD EAVE DETAIL

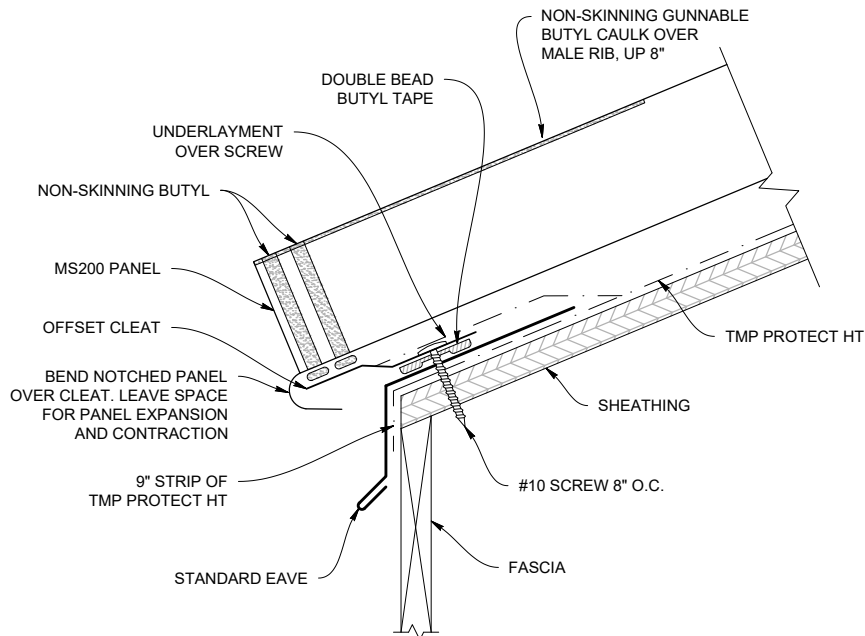

STANDARD EAVE (MS200ES)

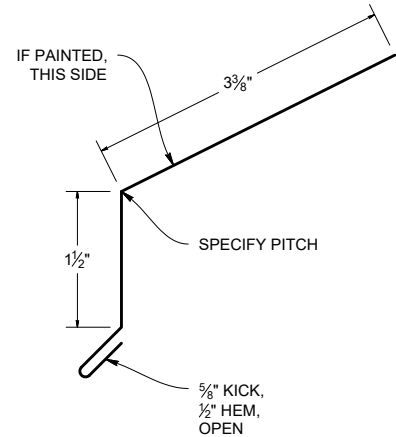

OFFSET CLEAT (MS200FMC)

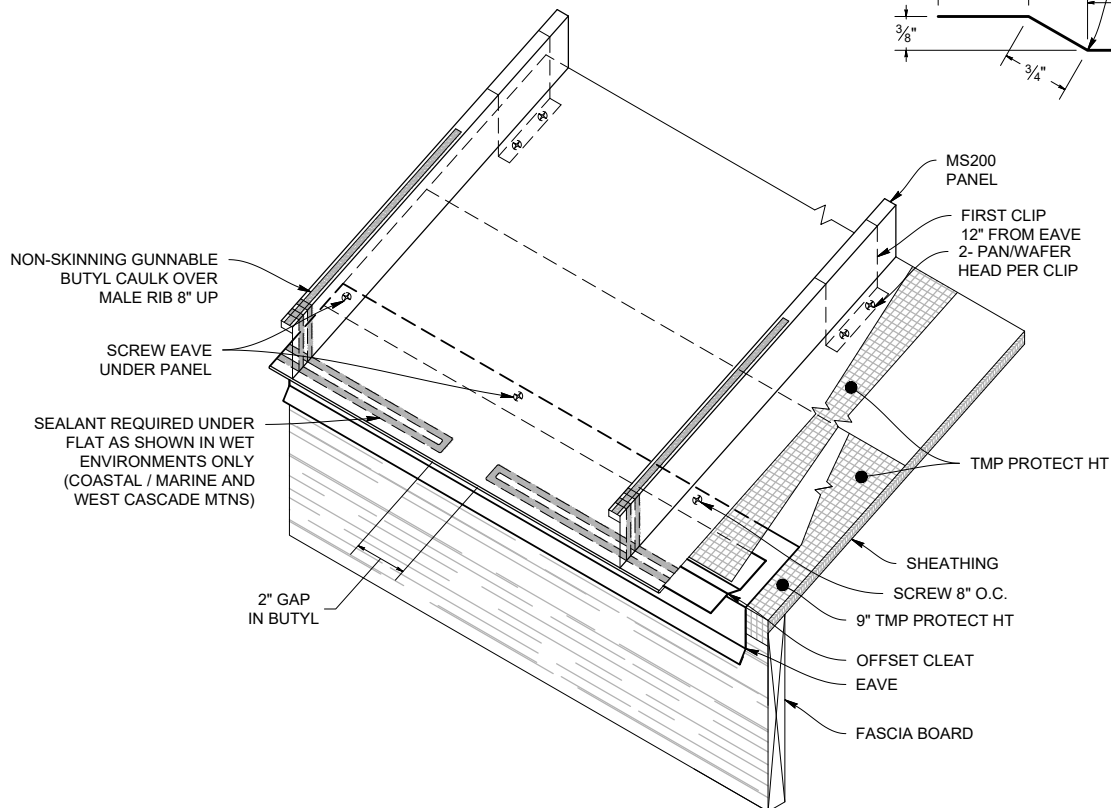
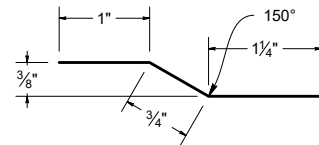

Note: All screws must be fastened into solid substrate.
Flashing must be lapped 4" with 3 rows of gunnable butyl.

Gutter / Hook Eave



HOOK EAVE WITH GUTTER DETAIL

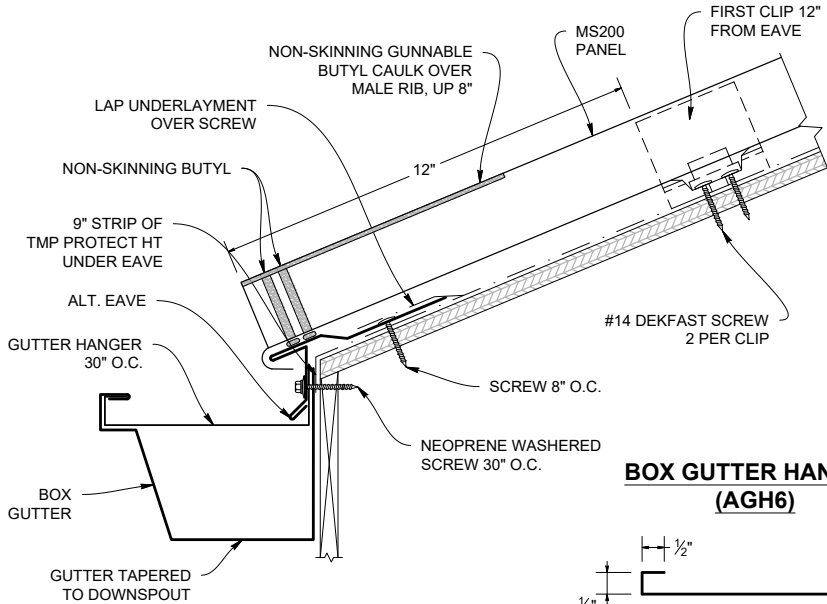

ALT. EAVE (MS200EA)

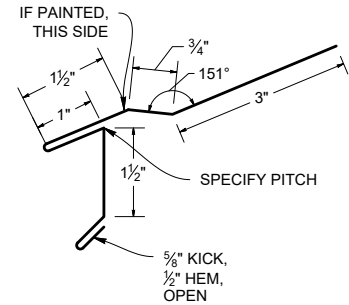

BOX GUTTER (MS200BG)

BOX GUTTER HANGER (AGH6)

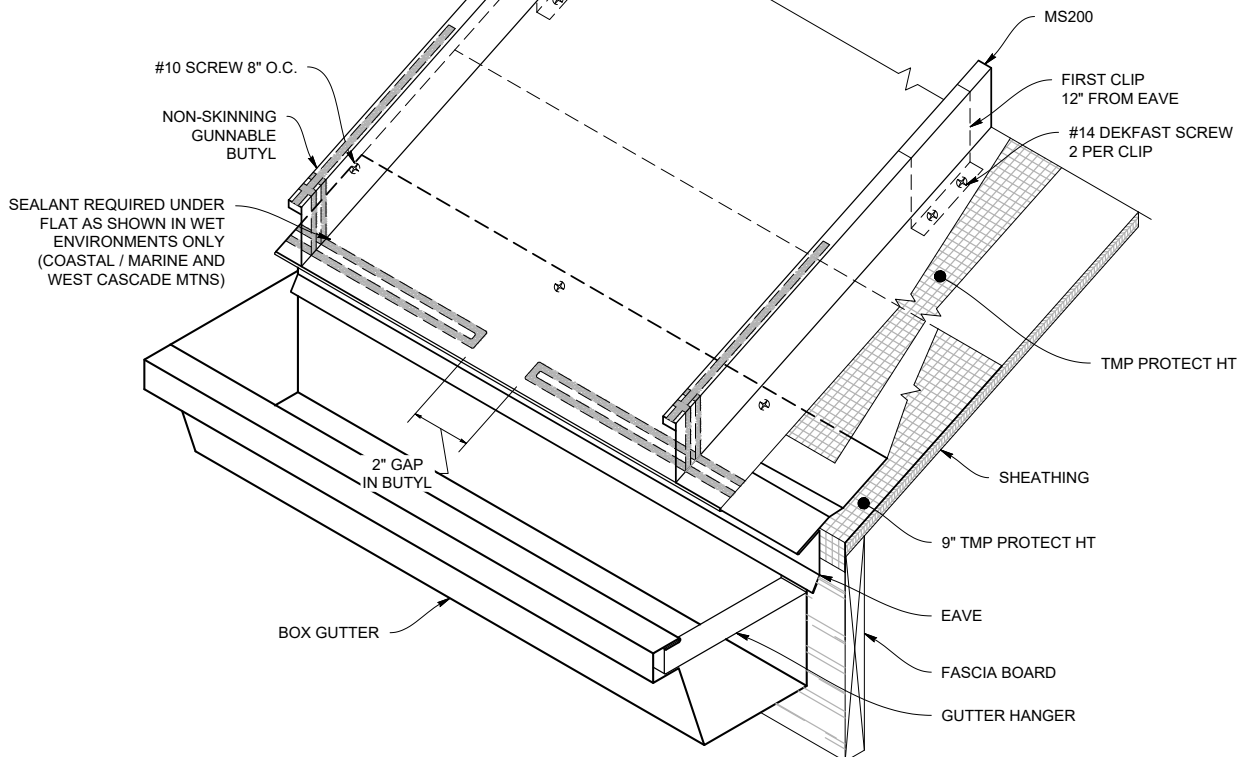
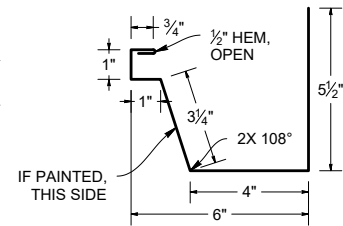
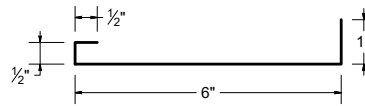

Note: All screws must be fastened into solid substrate.
Flashing must be lapped 4" with 3 rows of gunnable butyl.

STANDARD RIDGE DETAIL

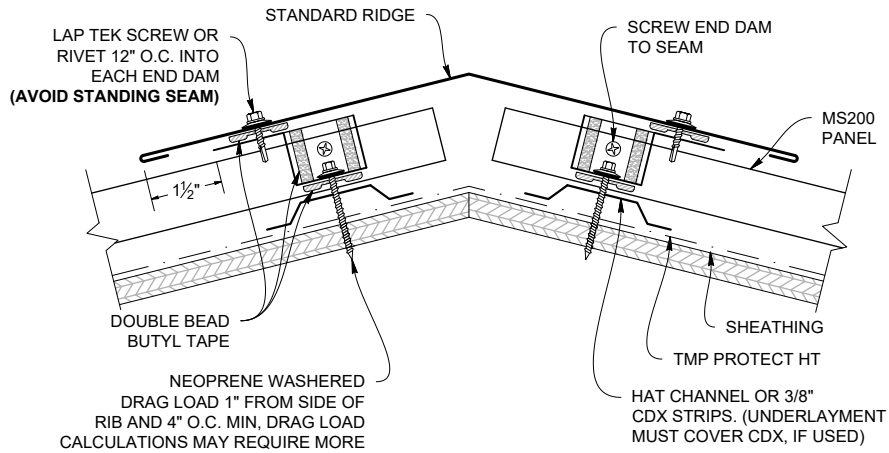

STANDARD RIDGE (MS200RS)

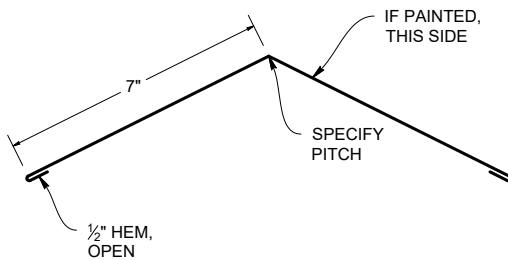

HAT FLASHING

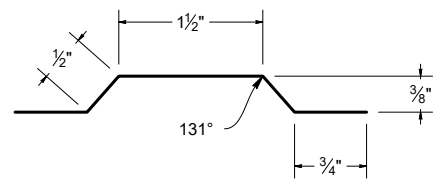

STANDARD RIDGE LAP

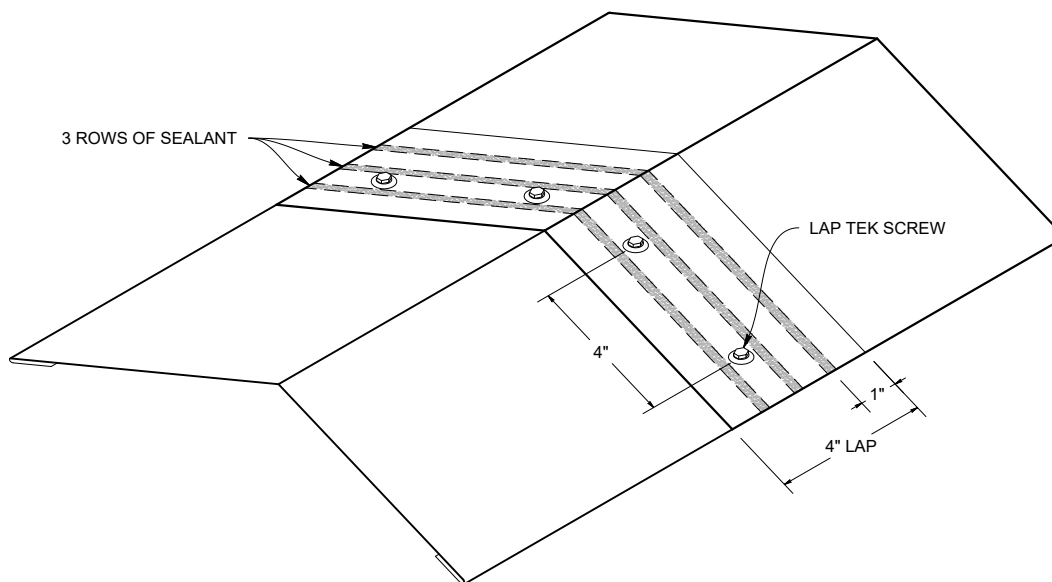

Note: All screws must be fastened into solid substrate.
Flashing must be lapped 4" with 3 rows of gunnable butyl.

Vented Ridge

WT VENTED RIDGE DETAIL

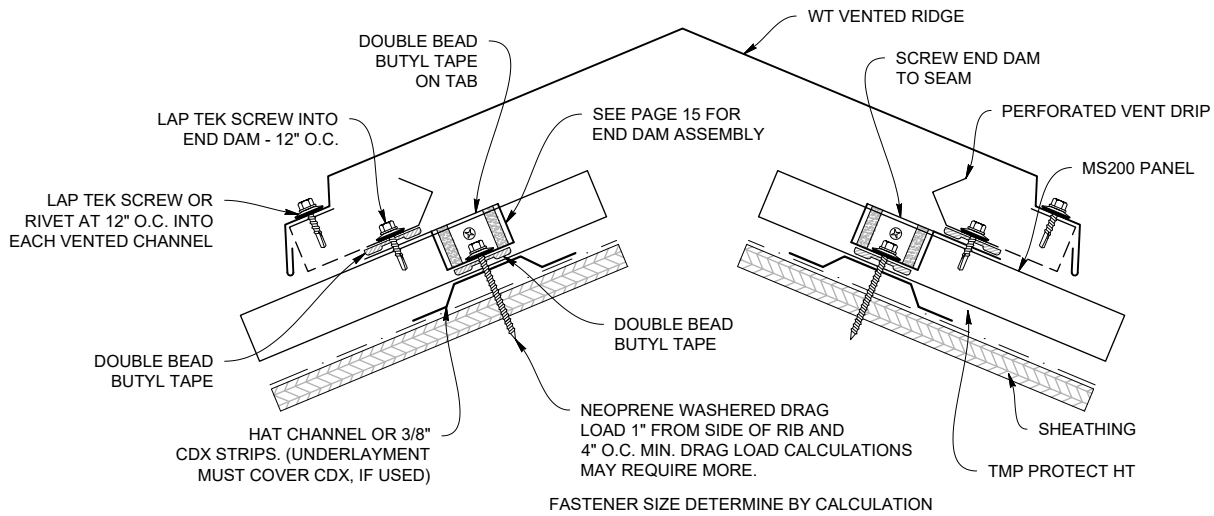

HAT FLASHING

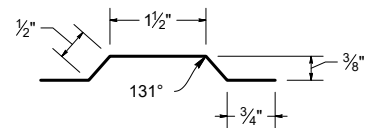

WT VENTED RIDGE (MS200WTRFV)

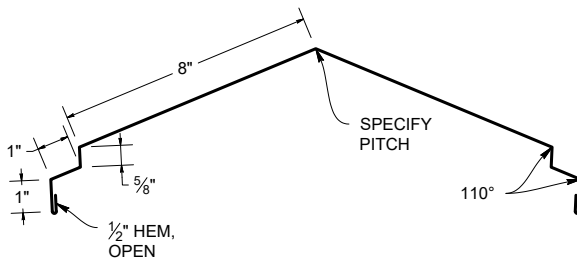

PERFORATED VENT DRIP (MS200PVD)

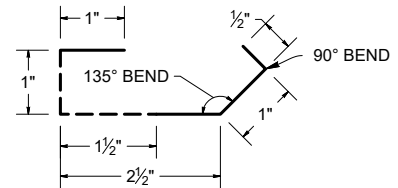

VENTED RIDGE LAP

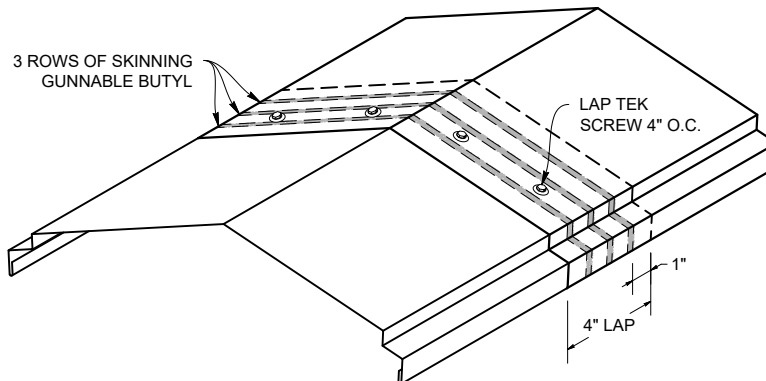

Note: All screws must be fastened into solid substrate.
Flashing must be lapped 4" with 3 rows of gunnable butyl.

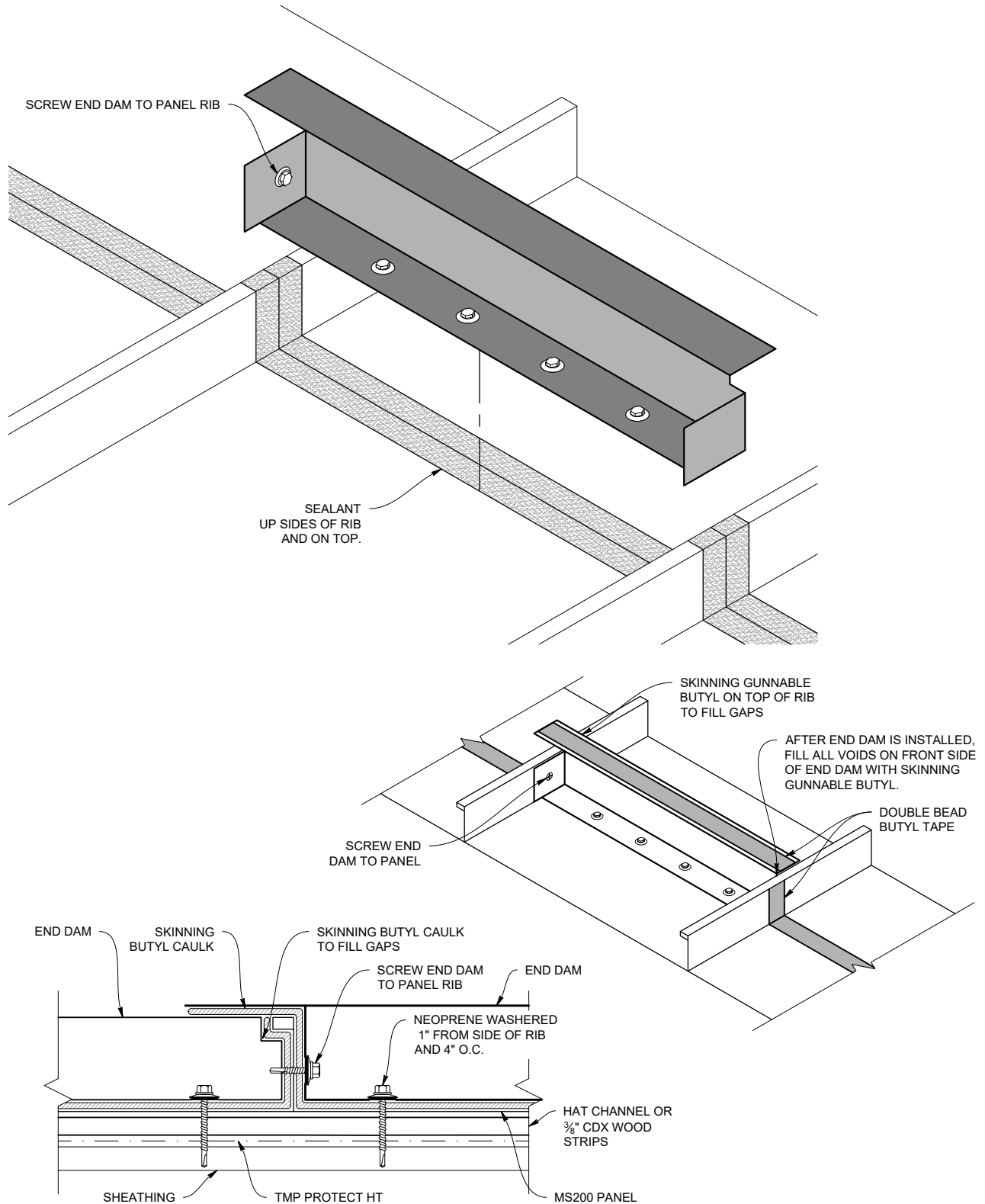

Note: All screws must be fastened into solid substrate.
Flashing must be lapped 4" with 3 rows of gunnable butyl.

Valley Flashing

Slope 3:12 or Greater

VALLEY DETAIL

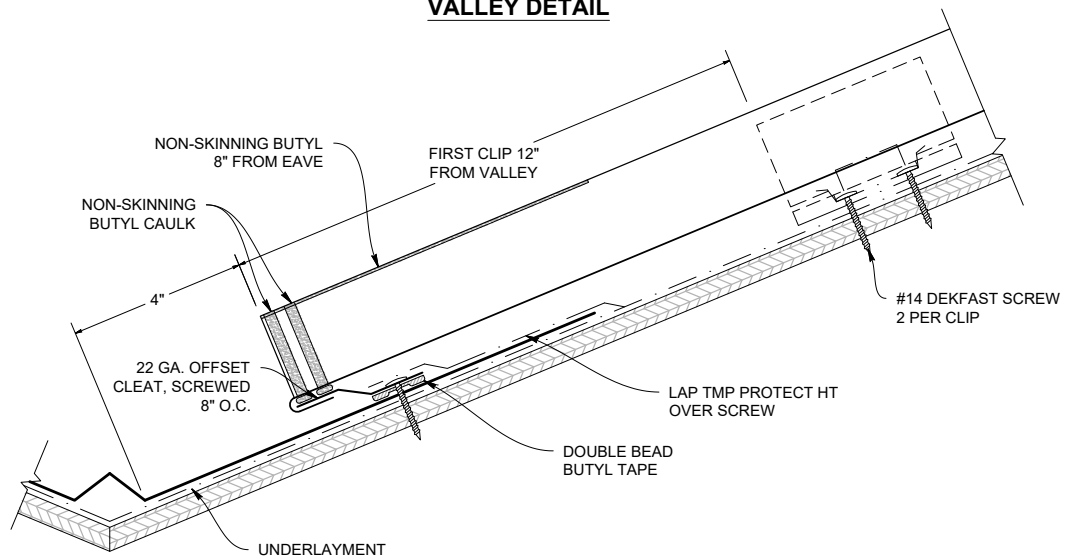

VALLEY (MS200VF)

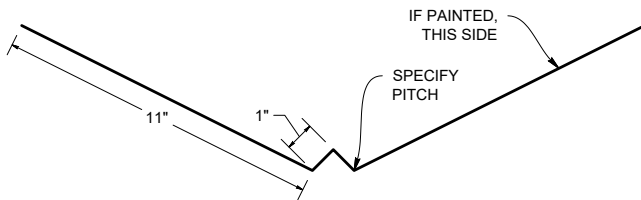

OFFSET CLEAT (MS200FMO)

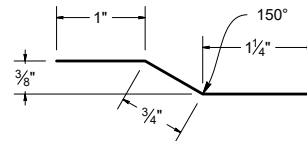

VALLEY LAP 3/12 or Greater Pitch

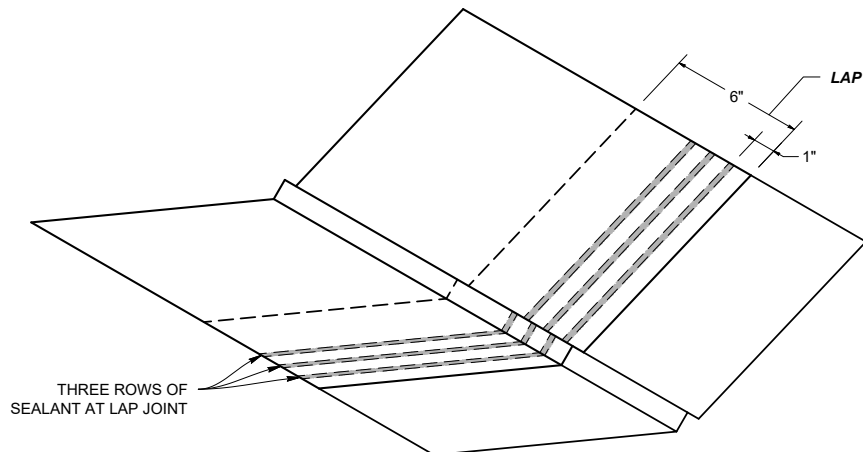

Note: All screws must be fastened into solid substrate.
Flashing must be lapped 4" with 3 rows of gunnable butyl.

LOW SLOPE VALLEY DETAIL (Less Than 3:12 Pitch)

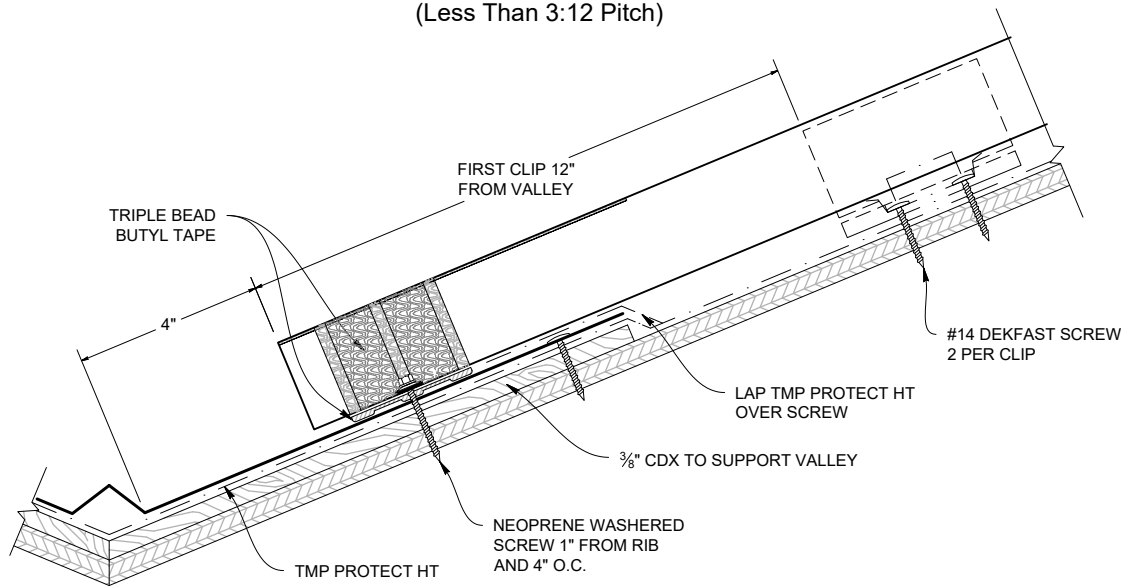

VALLEY FLASHING (MS200VF)

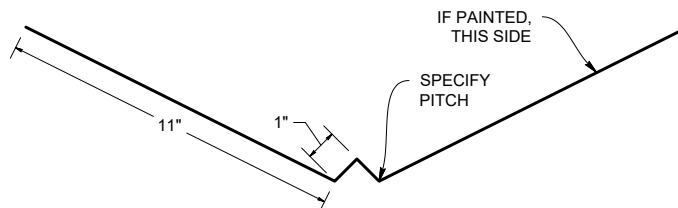

LOW SLOPE VALLEY LAP

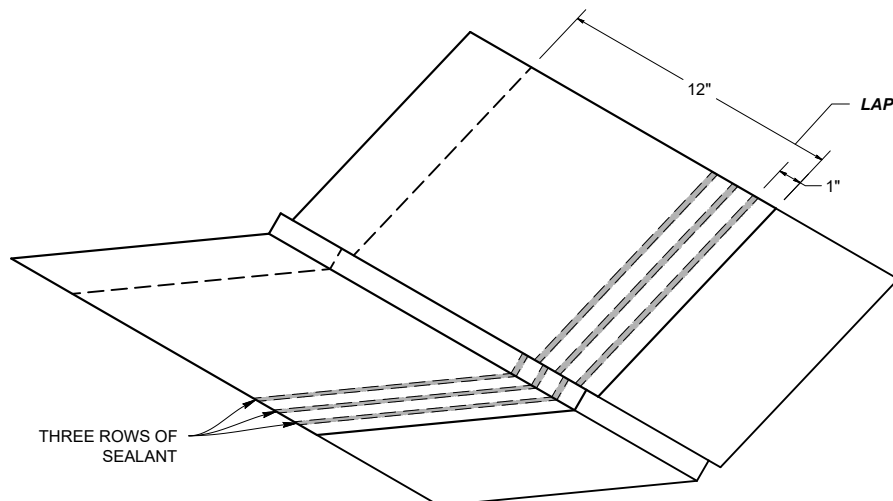

Note: All screws must be fastened into solid substrate.
Flashing must be lapped 4" with 3 rows of gunnable butyl.

Standard Gable

STD. GABLE DETAIL

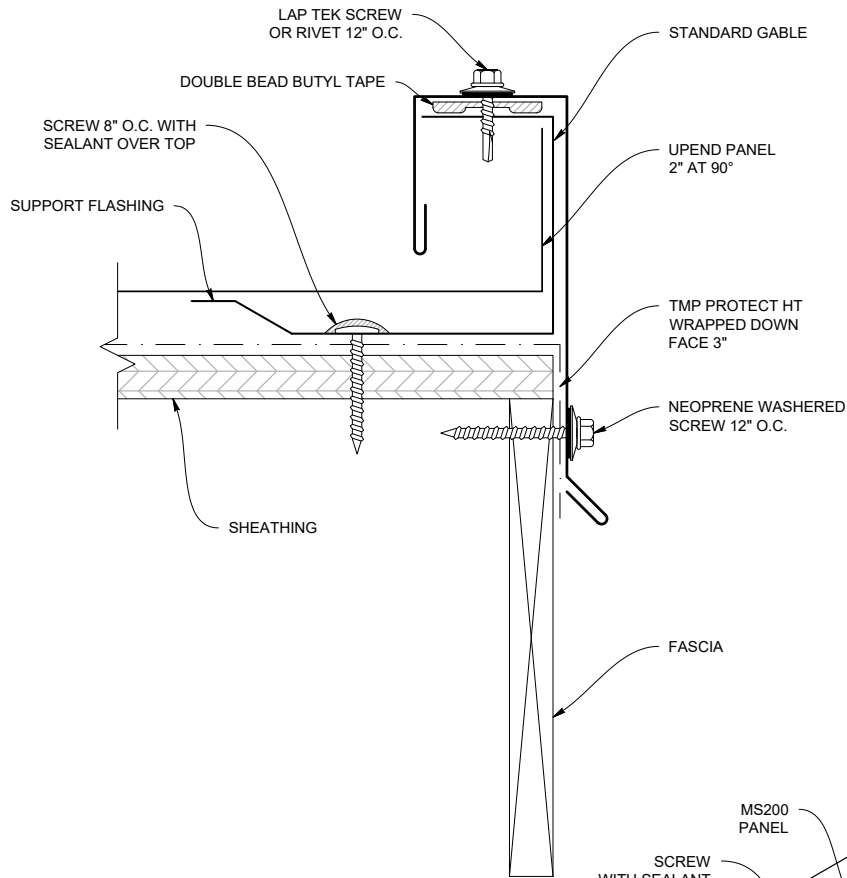

STD. GABLE (MS200GS)

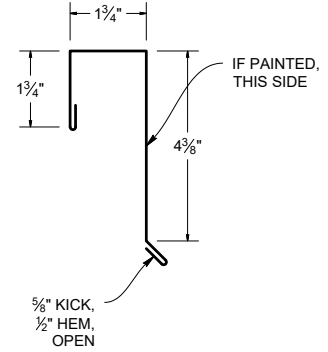

SUPPORT FLASHING (MS200FMSF)

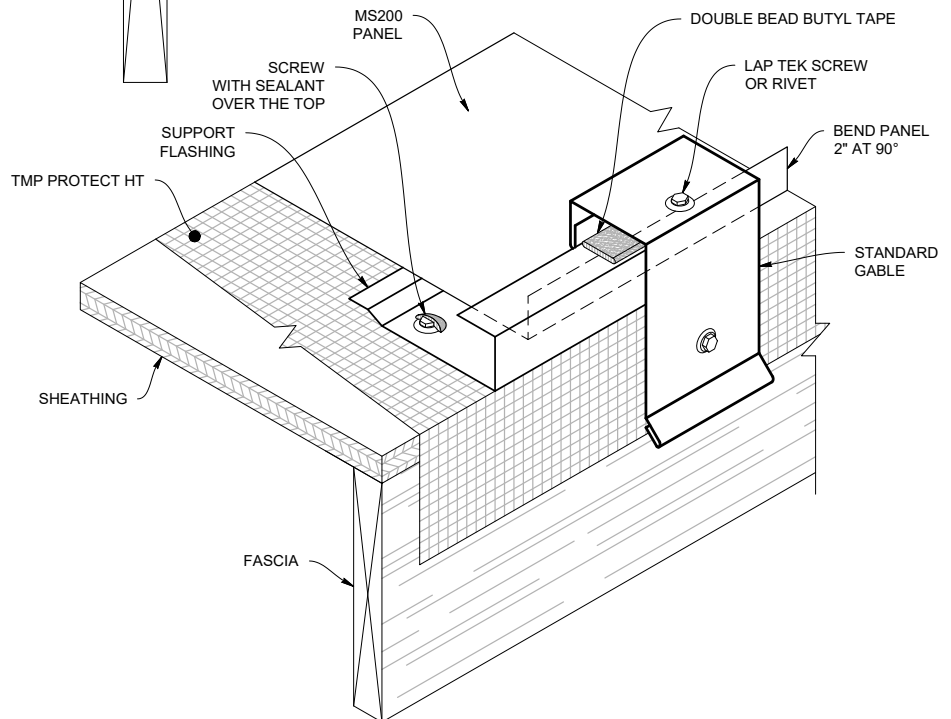
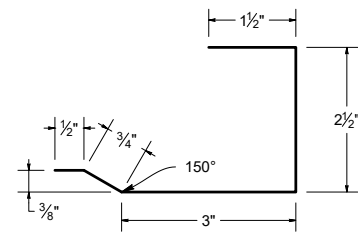

Note: All screws must be fastened into solid substrate.
Flashing must be lapped 4" with 3 rows of gunnable butyl.

ALT. GABLE DETAIL

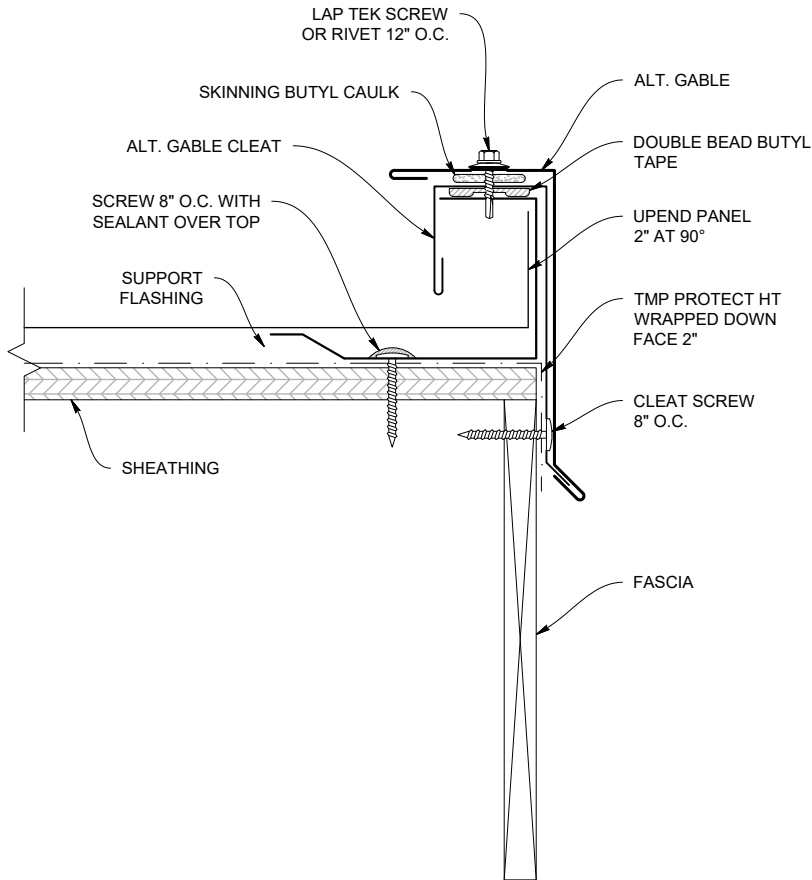

ALT. GABLE (MS200AT)

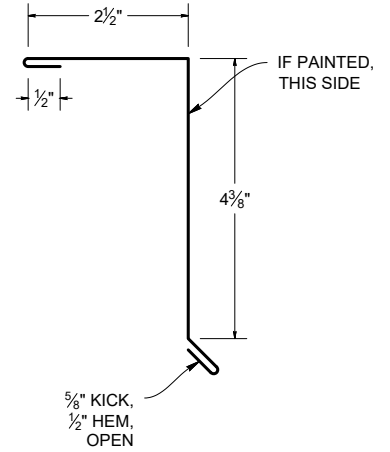

ALTERNATE GABLE CLEAT (MS200AGC)

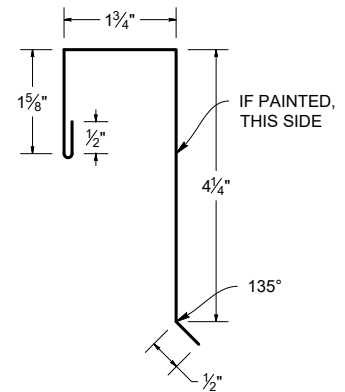

SUPPORT FLASHING (MS200FMSF)

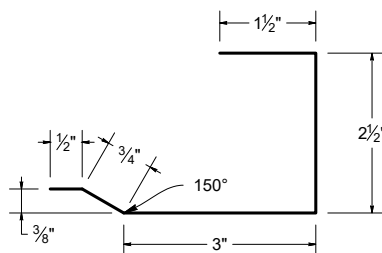

Note: All screws must be fastened into solid substrate.
Flashing must be lapped 4" with 3 rows of gunnable butyl.

SIDEWALL DETAIL

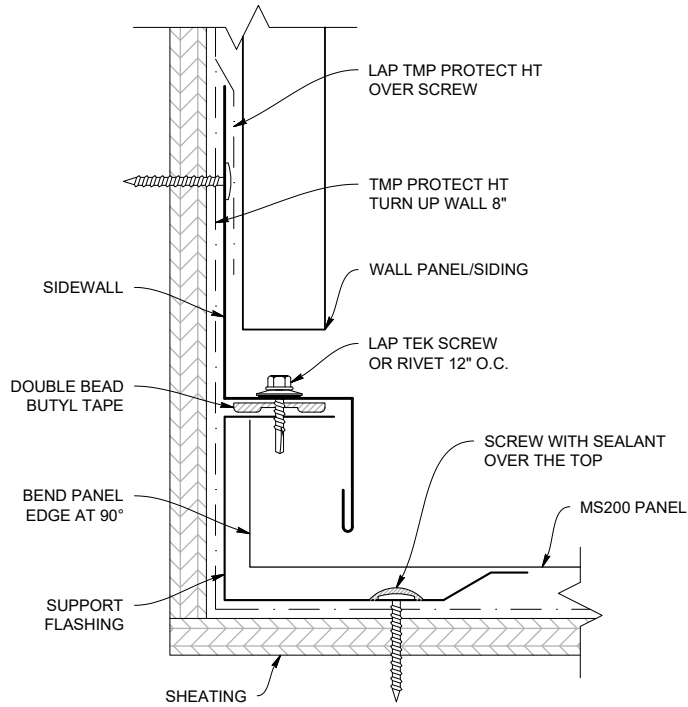

SIDEWALL (MS200SW)

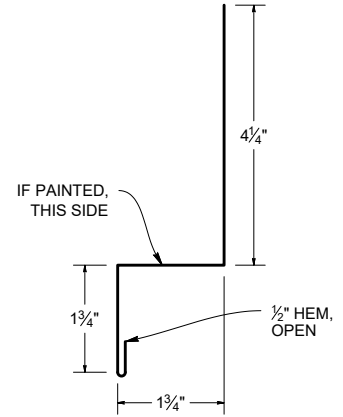

SUPPORT FLASHING (MS200FMSF)

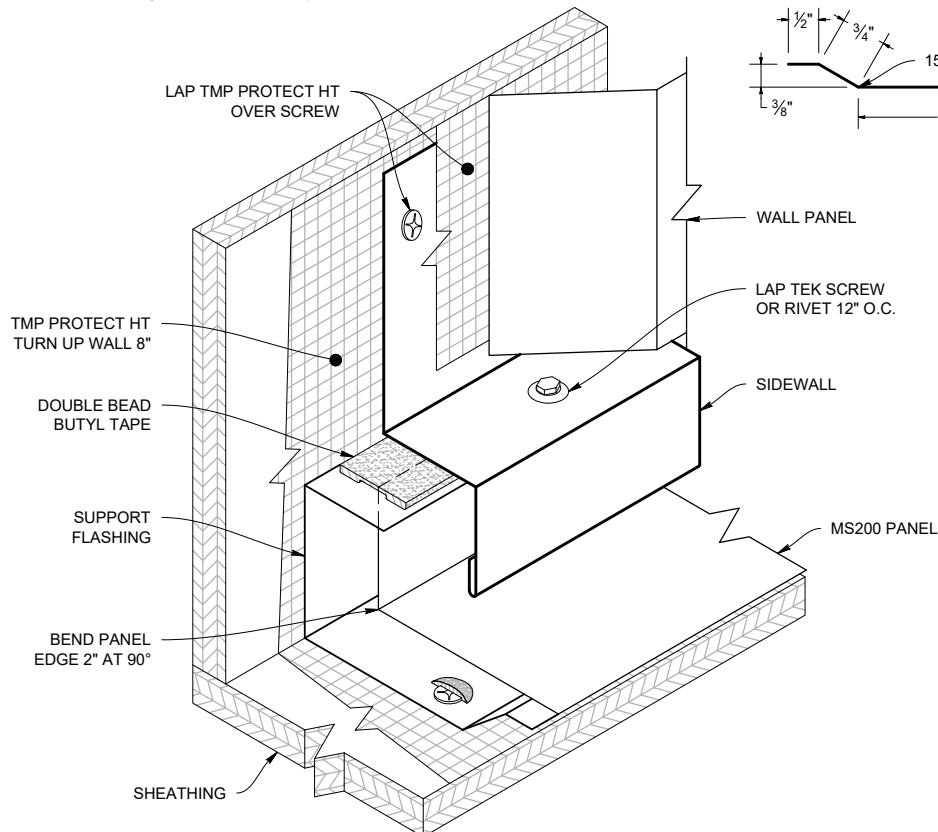
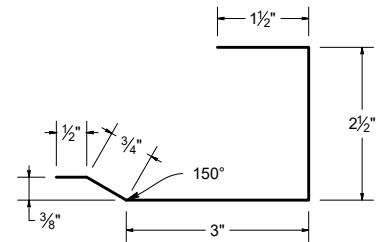

Note: All screws must be fastened into solid substrate.
Flashing must be lapped 4" with 3 rows of gunnable butyl.

PEAK FLASHING DETAIL

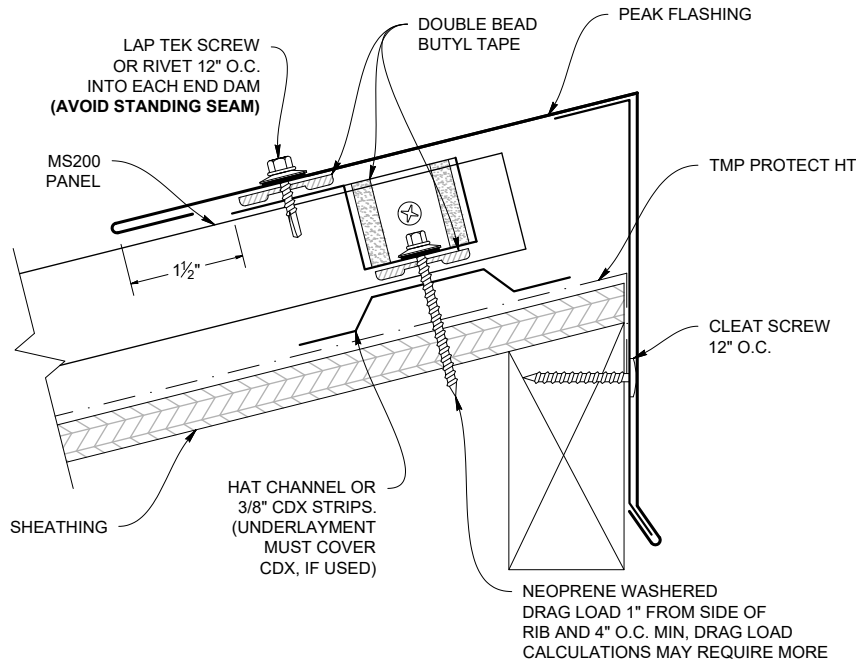

PEAK FLASHING (MS200REC)

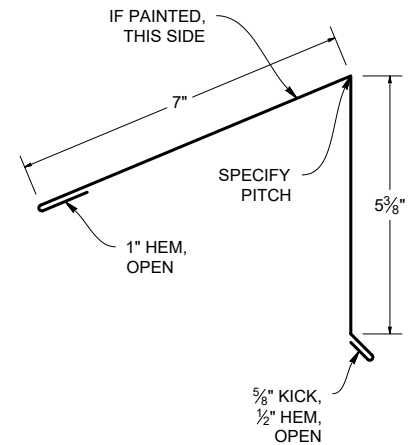

PEAK CLEAT (MS200RECC)

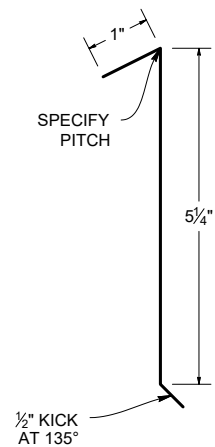

PEAK FLASHING LAP

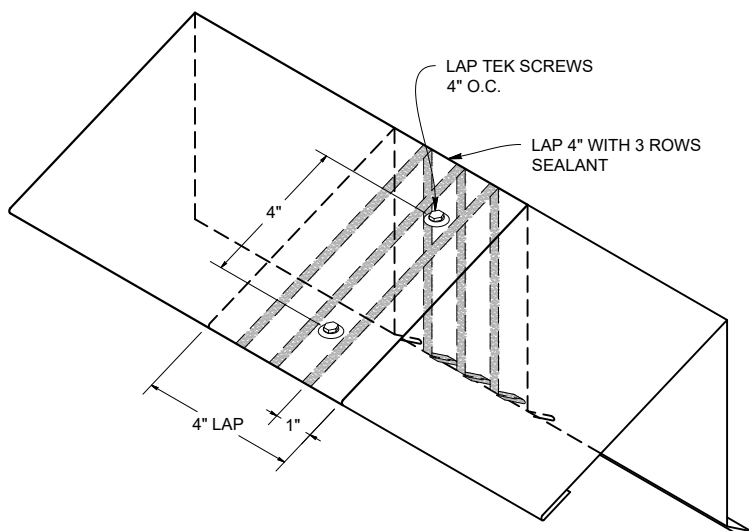

HAT CHANNEL FLASHING

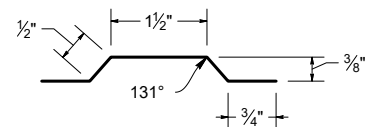

Note: All screws must be fastened into solid substrate.
Flashing must be lapped 4" with 3 rows of gunnable butyl.

Vented Peak Flashing

(Vented Ridge End Cap)



WT VENTED PEAK FLASHING DETAIL

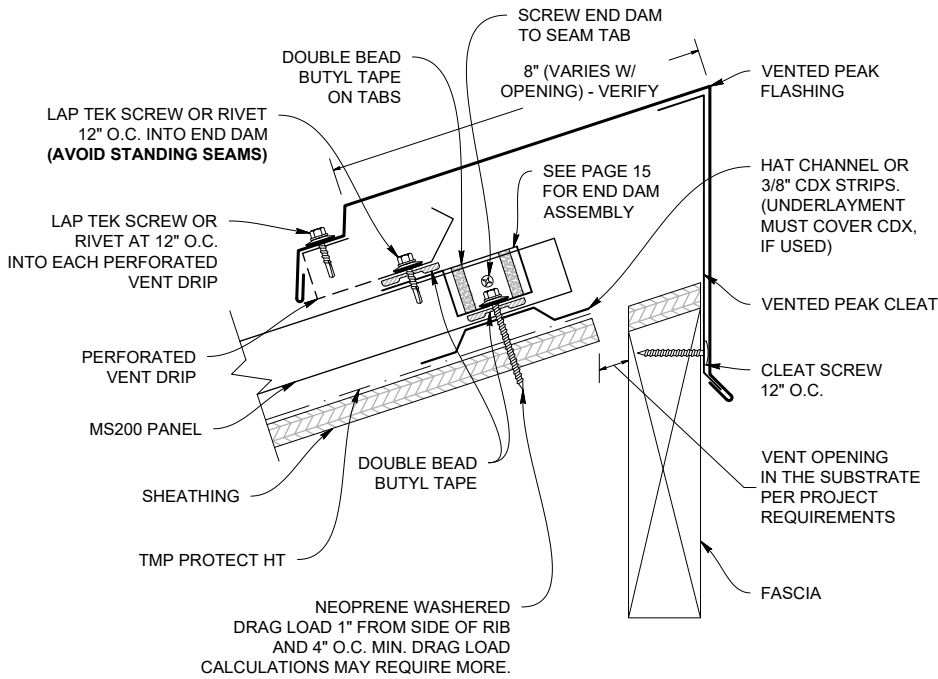

WT PEAK FLASHING (MS200WTRECV)

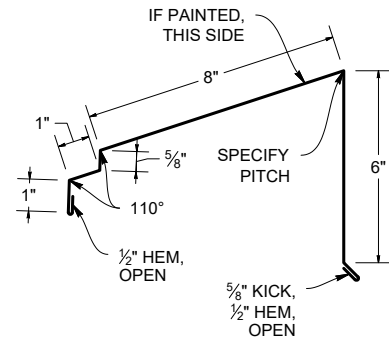

VENTED PEAK CLEAT (MS200VRECC)

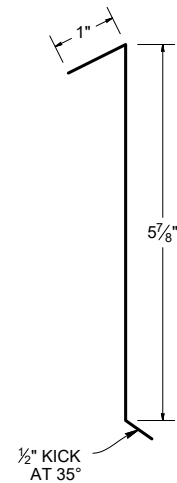

VENTED PEAK FLASHING LAP

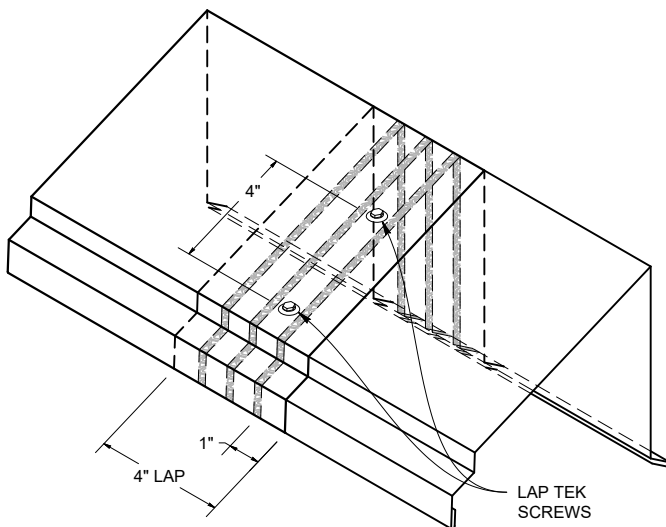

PERFORATED VENT DRIP (MS200PVD)

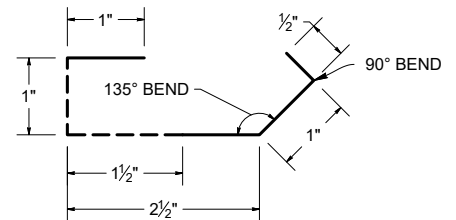

HAT FLASHING

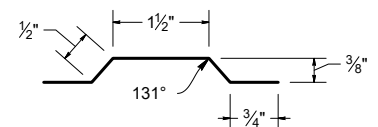

Note: All screws must be fastened into solid substrate.
Flashing must be lapped 4" with 3 rows of gunnable butyl.

PITCH CHANGE DETAIL

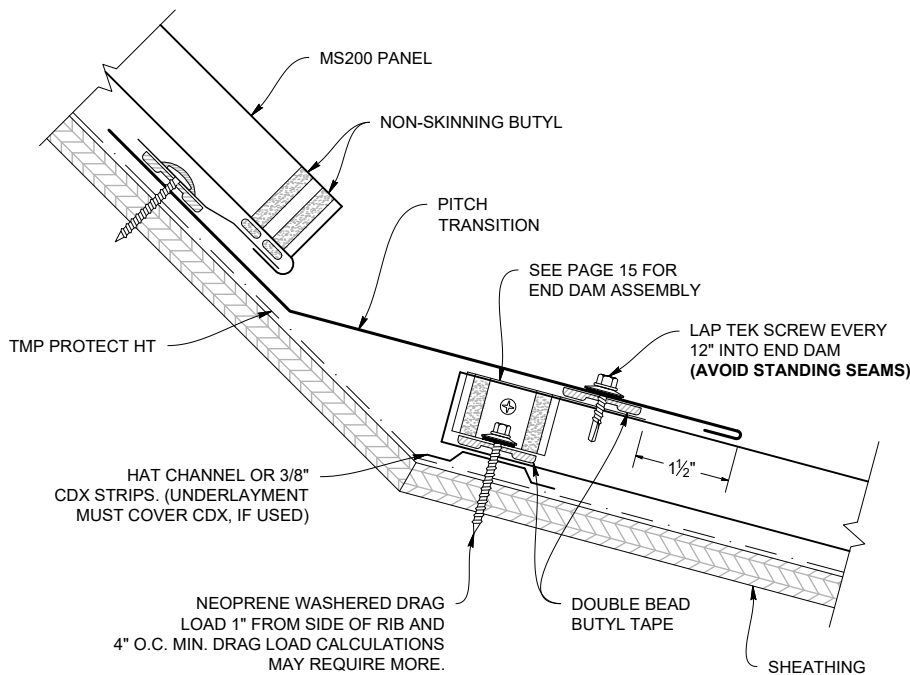

INSIDE PITCH CHANGE FLASHING

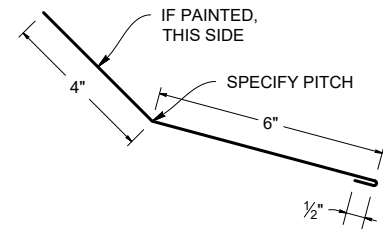

OFFSET CLEAT (MS200FMOC)

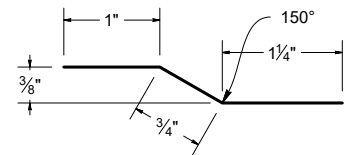

PITCH CHANGE LAP

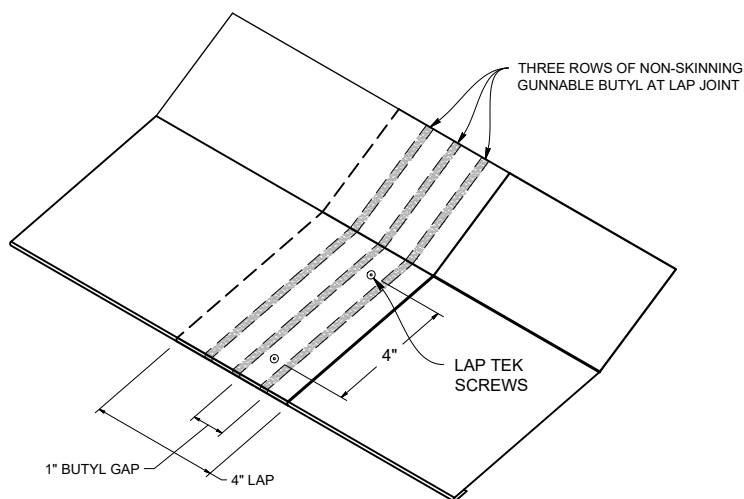

HAT FLASHING

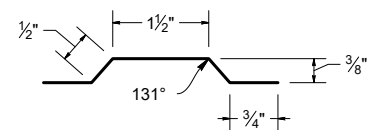

Note: All screws must be fastened into solid substrate.
Flashing must be lapped 4" with 3 rows of gunnable butyl.

ENDWALL DETAIL

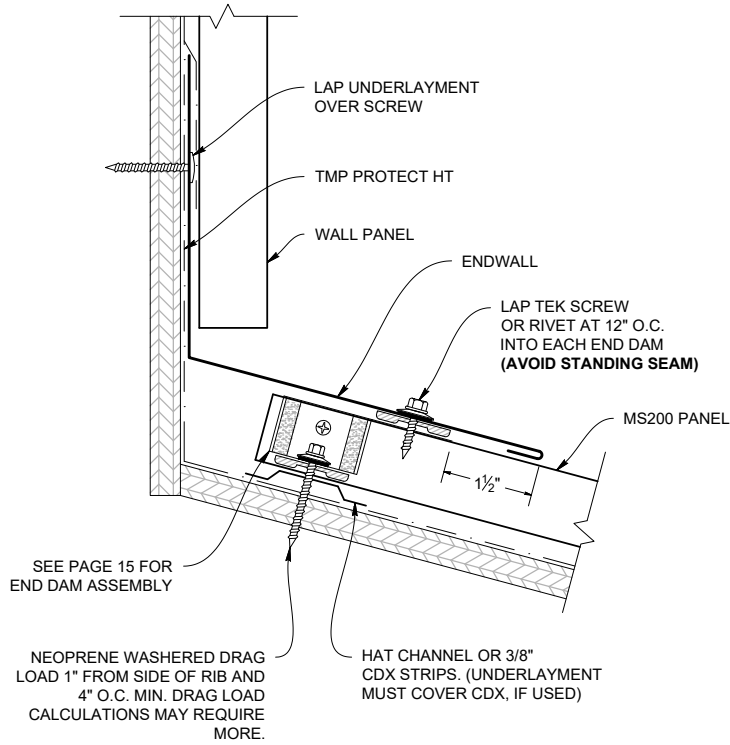

ENDWALL (MS200EW)

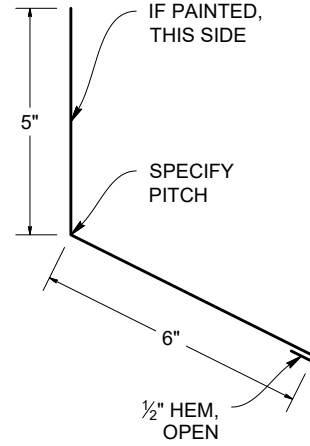

HAT FLASHING

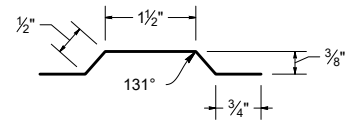

ENDWALL LAP

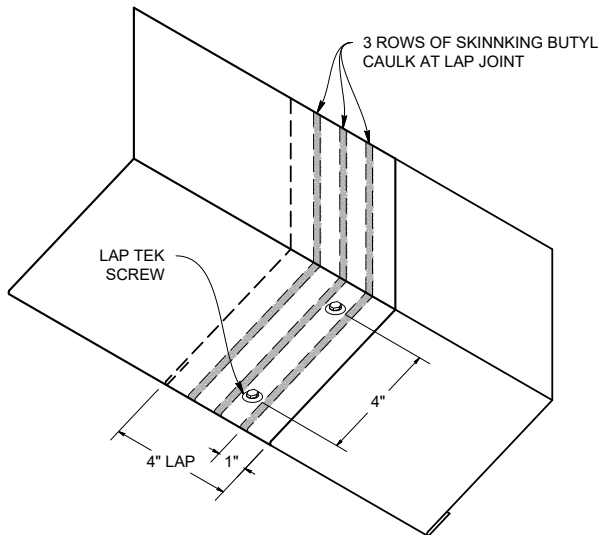

ENDWALL DETAIL

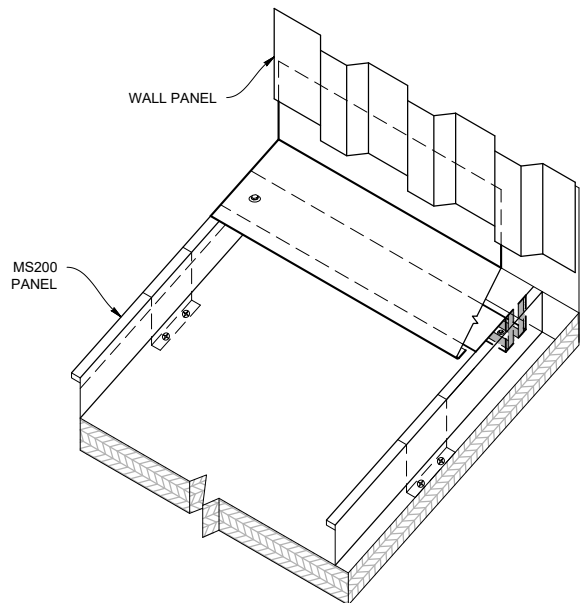

Note: All screws must be fastened into solid substrate.
Flashing must be lapped 4" with 3 rows of gunnable butyl.

WT VENTED ENDWALL DETAIL

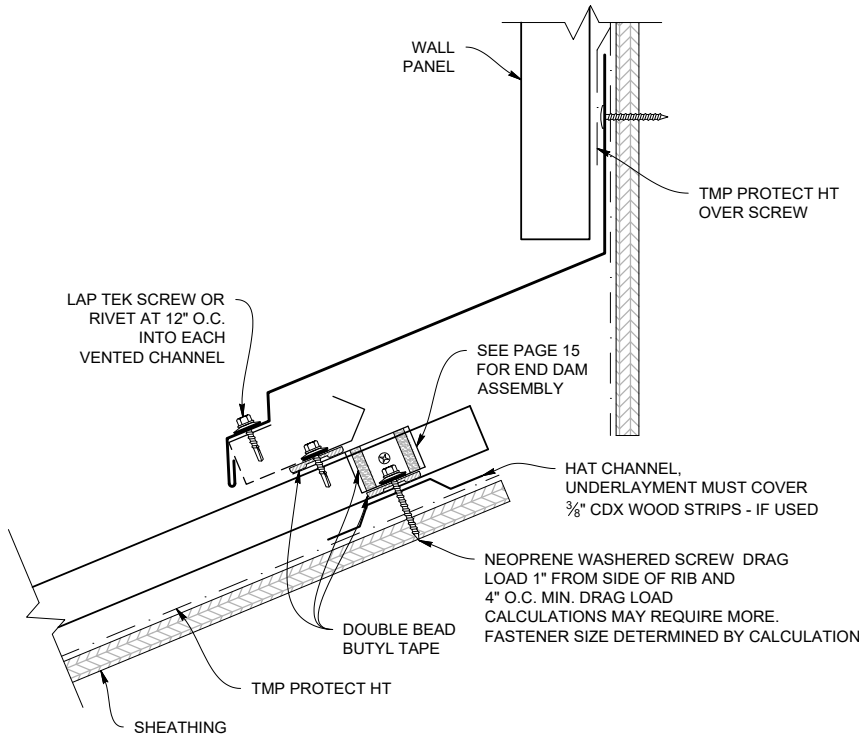

WT VENTED ENDWALL (MS200WTEWV)

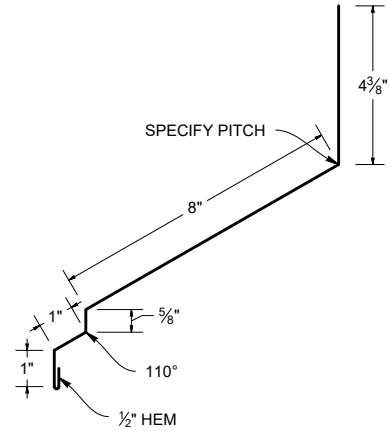

PERFORATED VENT DRIP (MS200PVD)

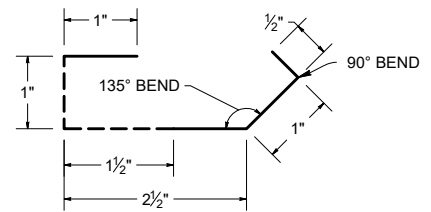

VENTED ENDWALL WALL LAP

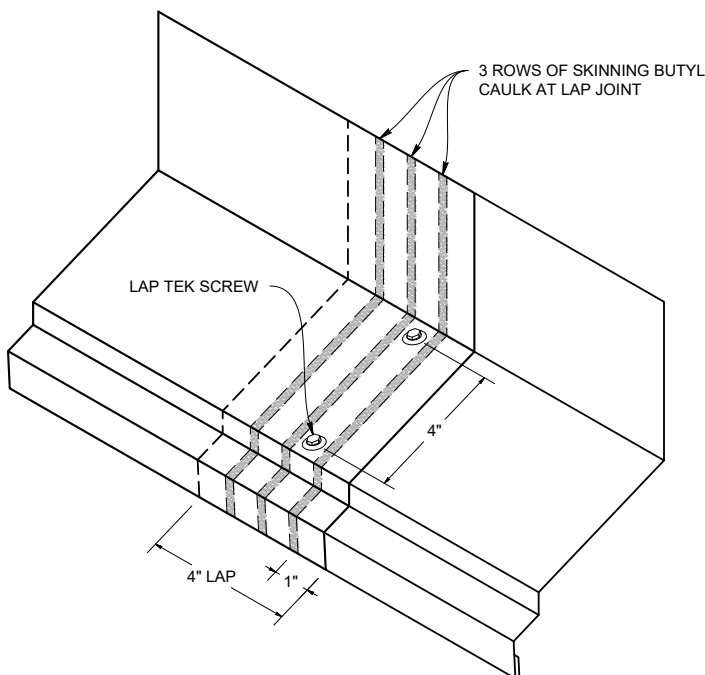

HAT FLASHING

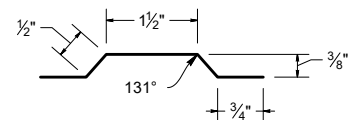

Note: All screws must be fastened into solid substrate.
Flashing must be lapped 4" with 3 rows of gunnable butyl.

Endwall w/ Saw Cut Reglet

SAW CUT ENDWALL DETAIL

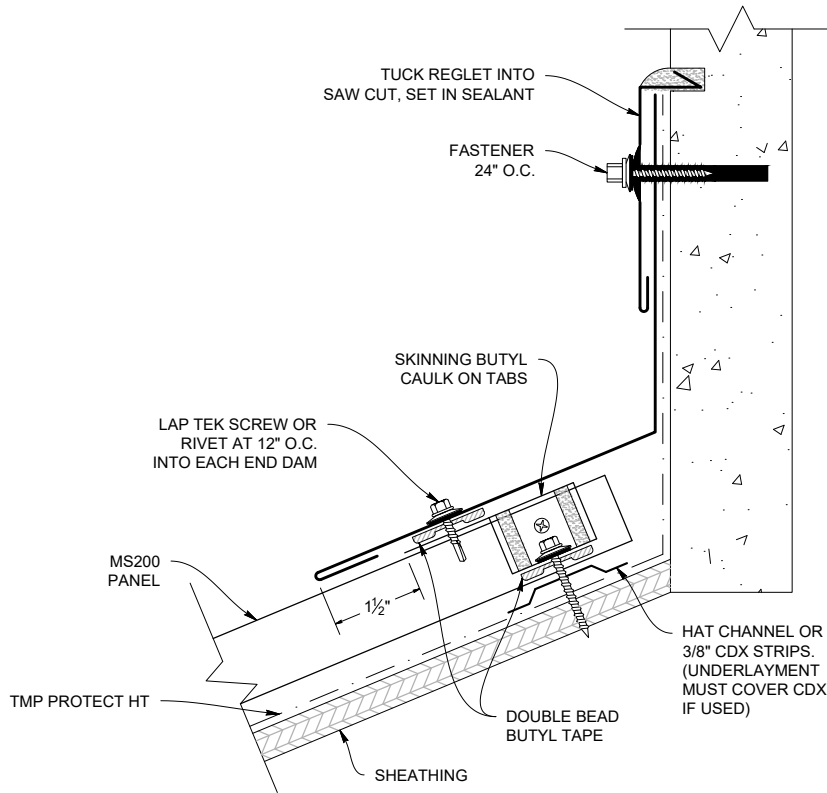

REGLET (MS200RF)

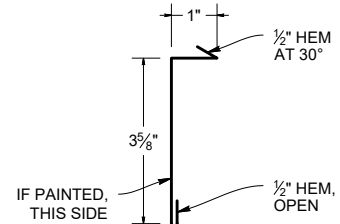

ENDWALL (MS200EW)

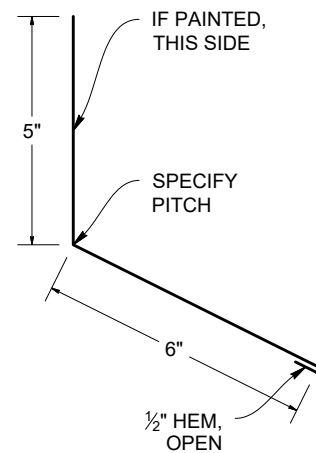

ENDWALL LAP

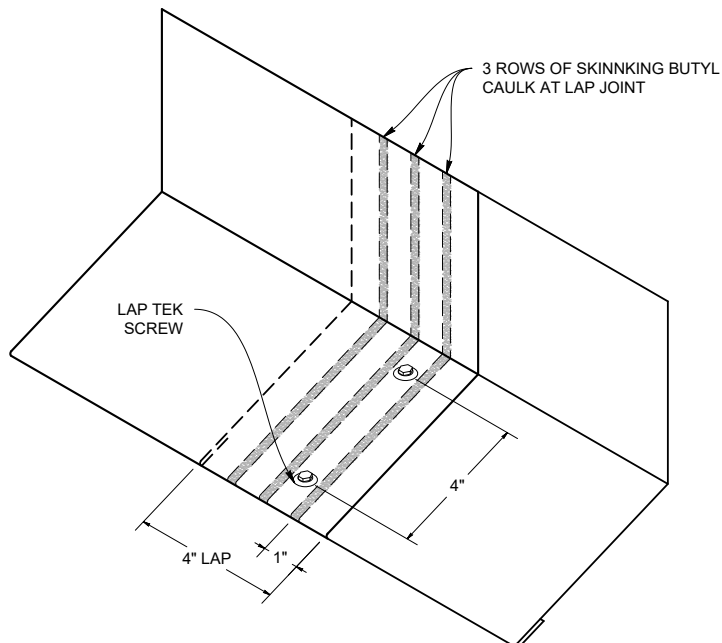

HAT FLASHING

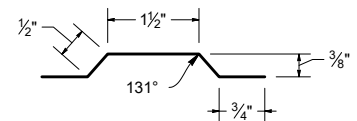

Note: All screws must be fastened into solid substrate.
Flashing must be lapped 4" with 3 rows of gunnable butyl.

STEP 1

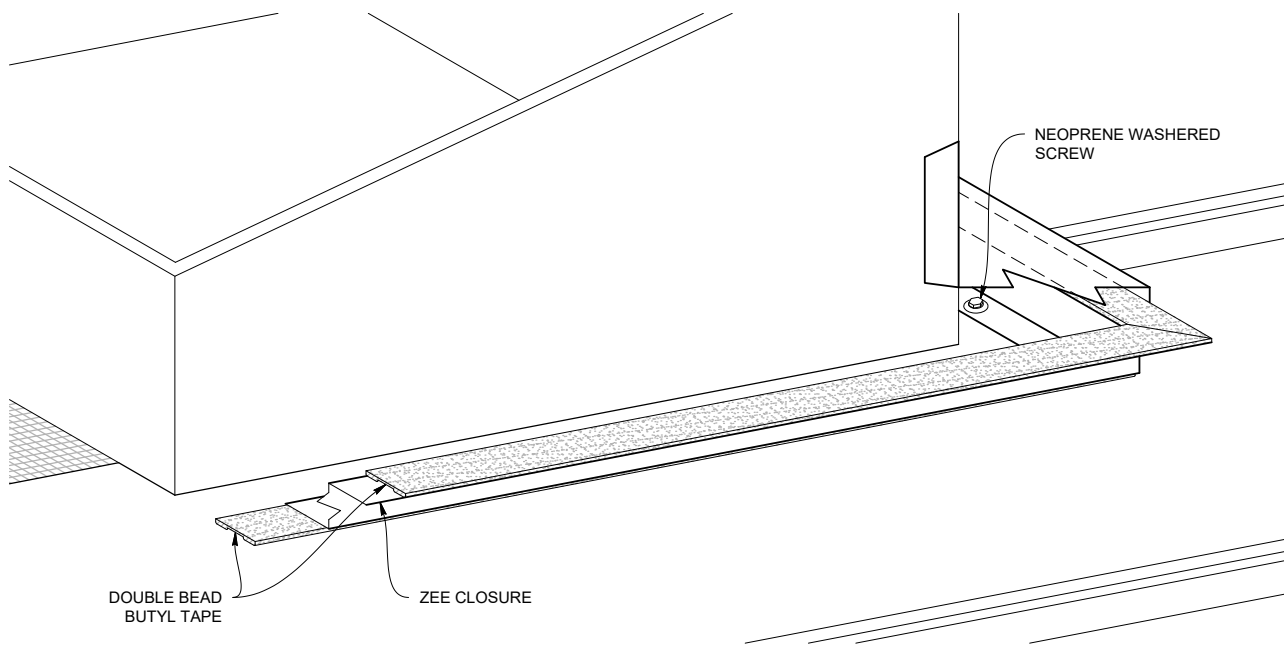

STEP 2

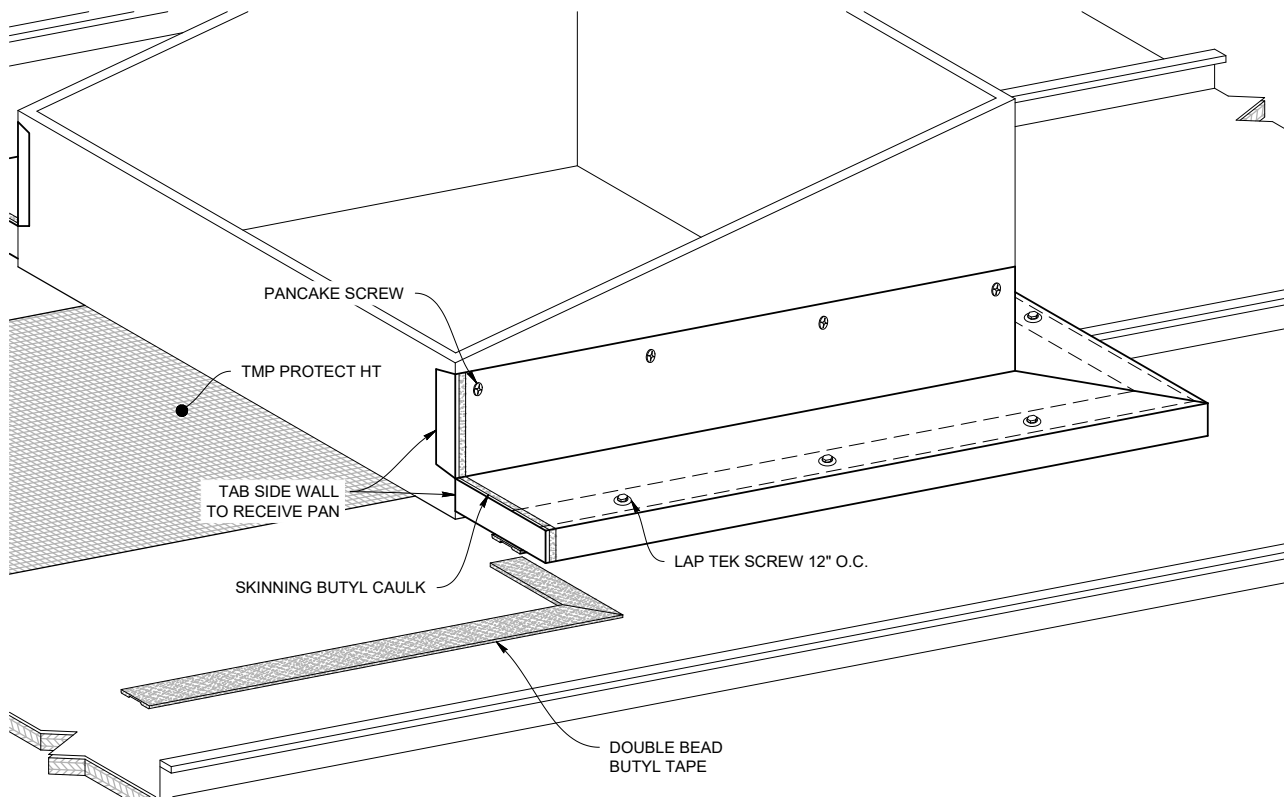

Note: All screws must be fastened into solid substrate.
Flashing must be lapped 4" with 3 rows of gunnable butyl.

Curb Back Pan / Cricket

STEP 3

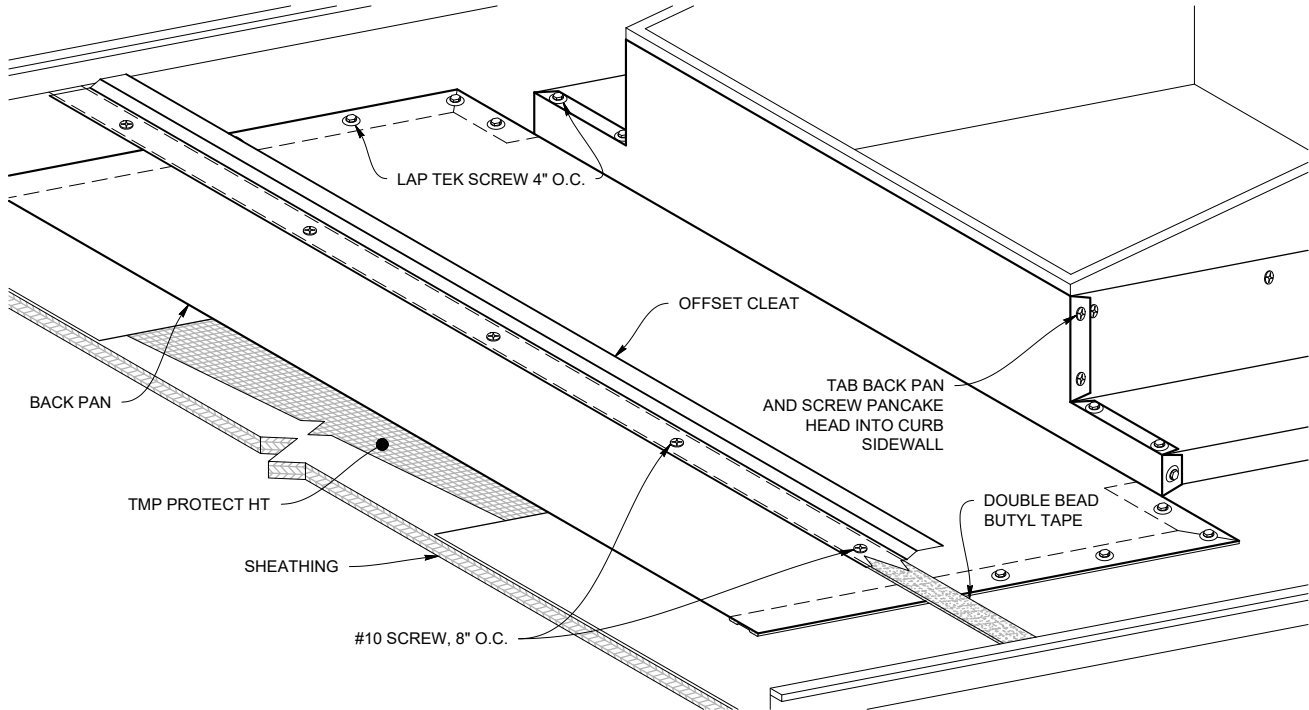

STEP 4

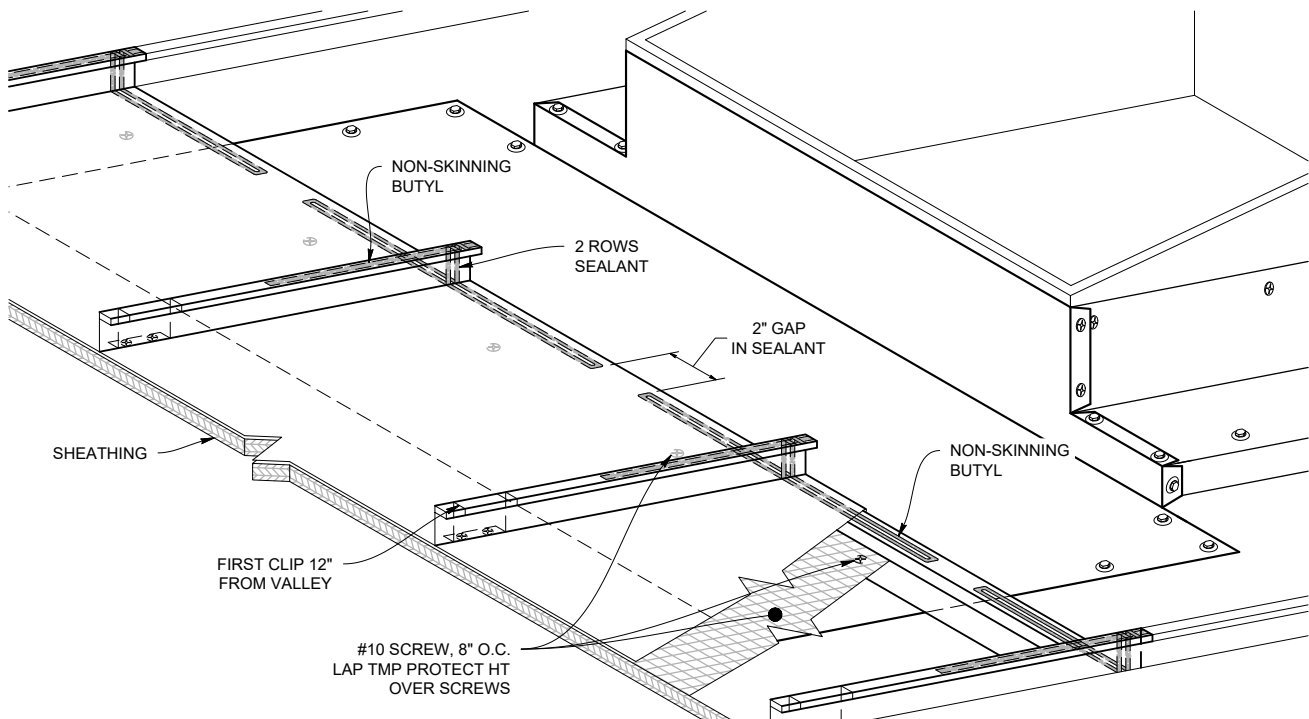

Note: All screws must be fastened into solid substrate.
Flashing must be lapped 4" with 3 rows of gunnable butyl.

STEP 5

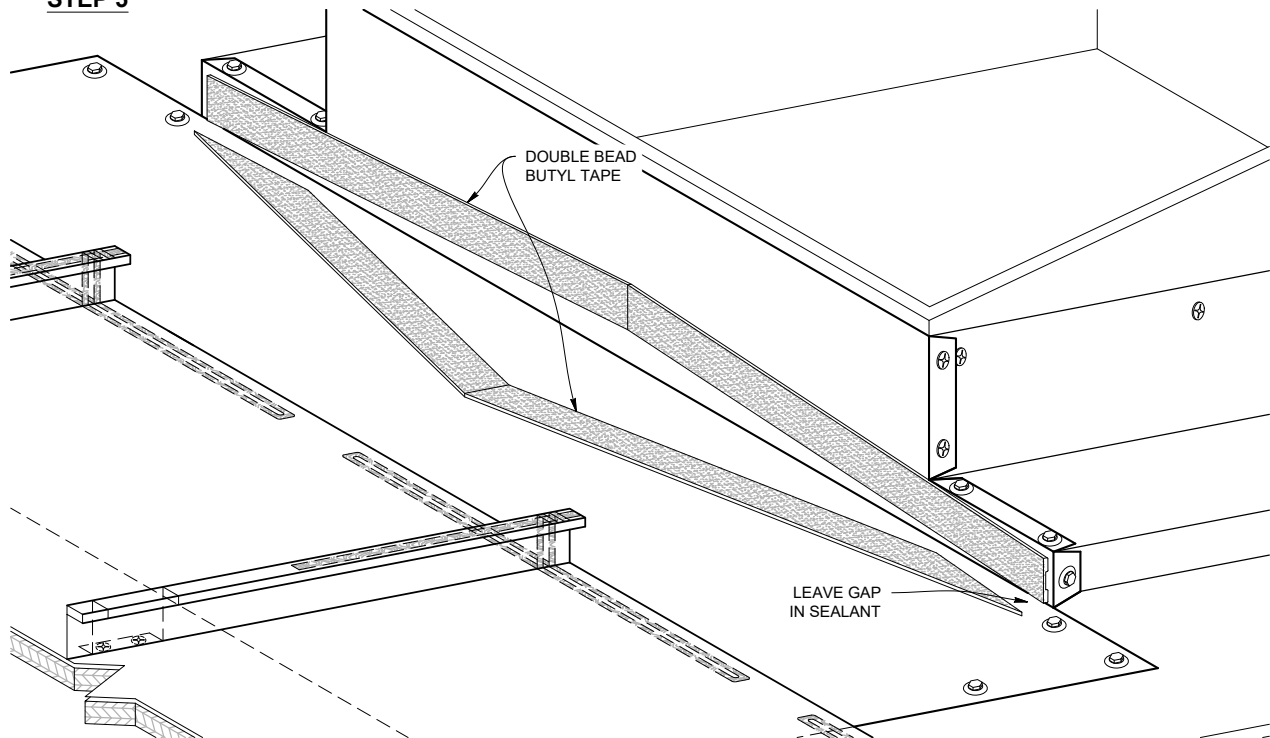

STEP 6

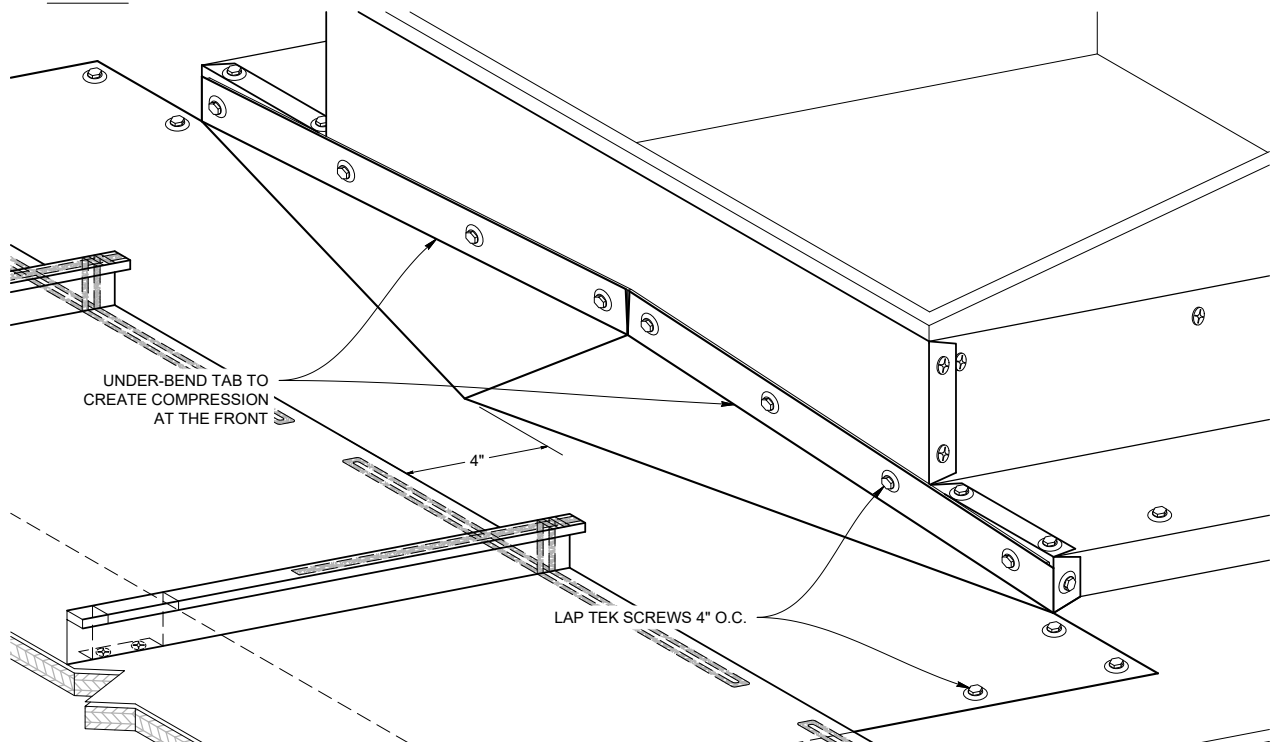

Note: All screws must be fastened into solid substrate.
Flashing must be lapped 4" with 3 rows of gunnable butyl.

CURB SIDEWALL DETAIL

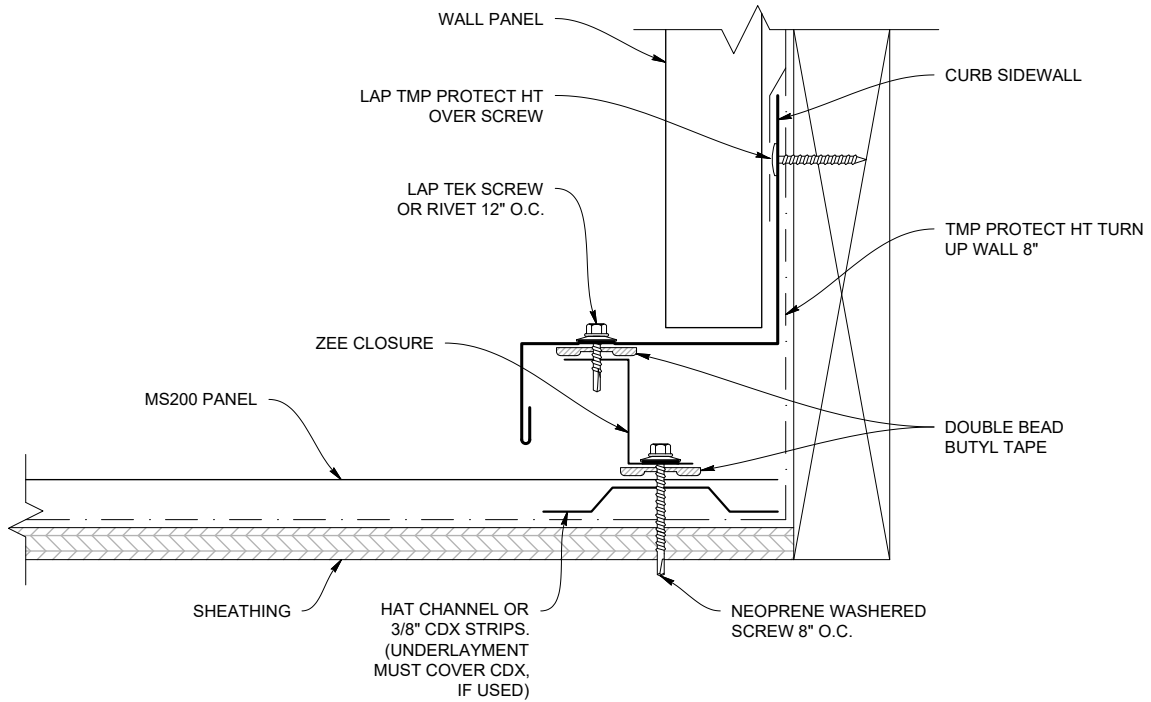

ZEE CLOSURE (MS200ZC)

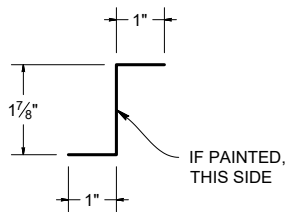

CURB SIDEWALL (MS200CSW)

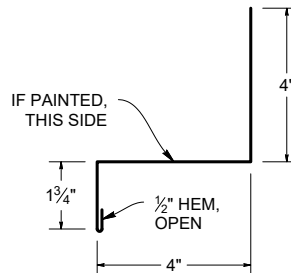

HAT FLASHING

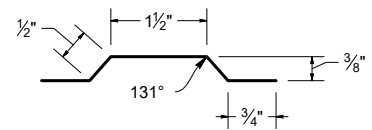

Note: All screws must be fastened into solid substrate.
Flashing must be lapped 4" with 3 rows of gunnable butyl.

CURB ENDWALL DETAIL

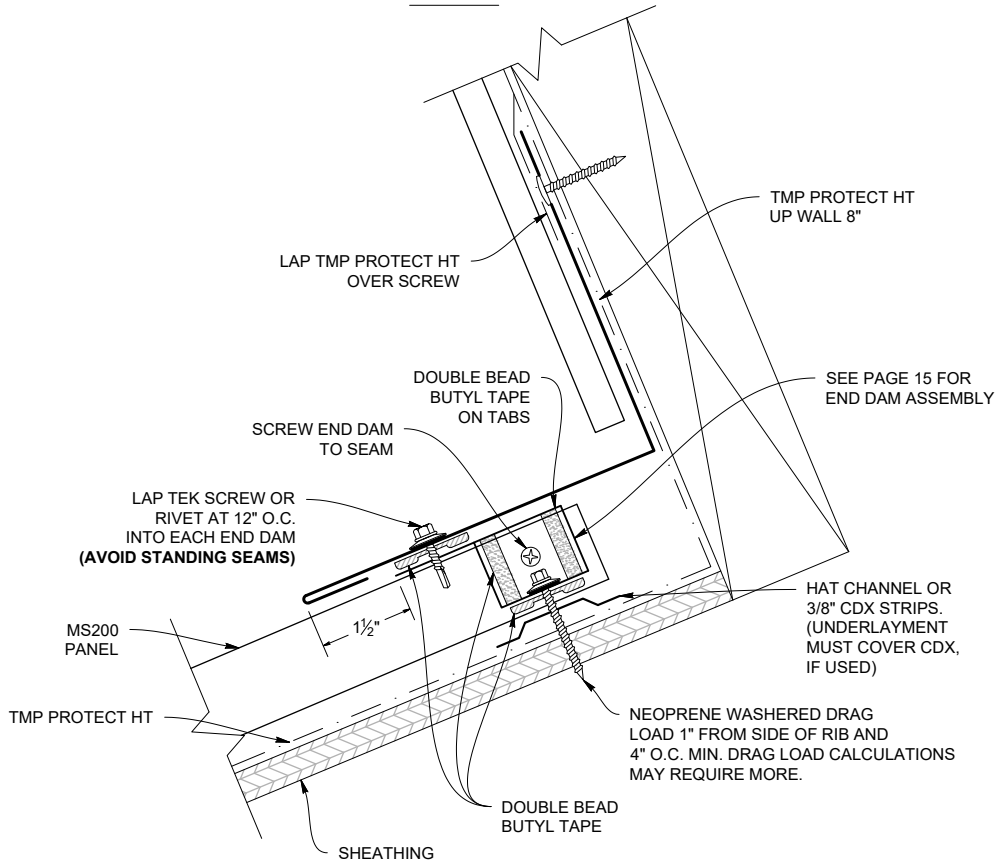

CURB ENDWALL (MS200CH)

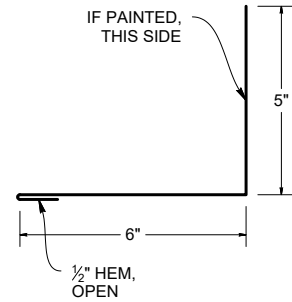

HAT FLASHING

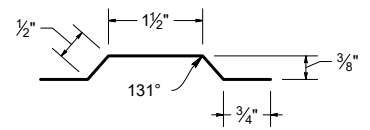

ENDWALL DETAIL

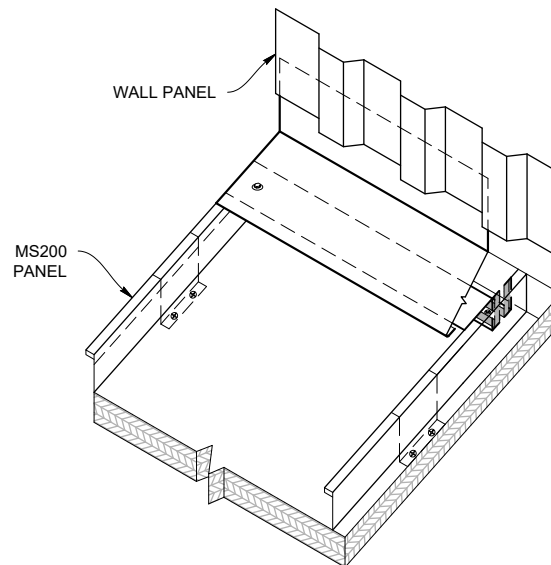

Note: All screws must be fastened into solid substrate.
Flashing must be lapped 4" with 3 rows of gunnable butyl.

Curb Back Pan / Cricket

**CURB / PAN CRICKET DETAIL
(3:12 Pitch or Greater)**

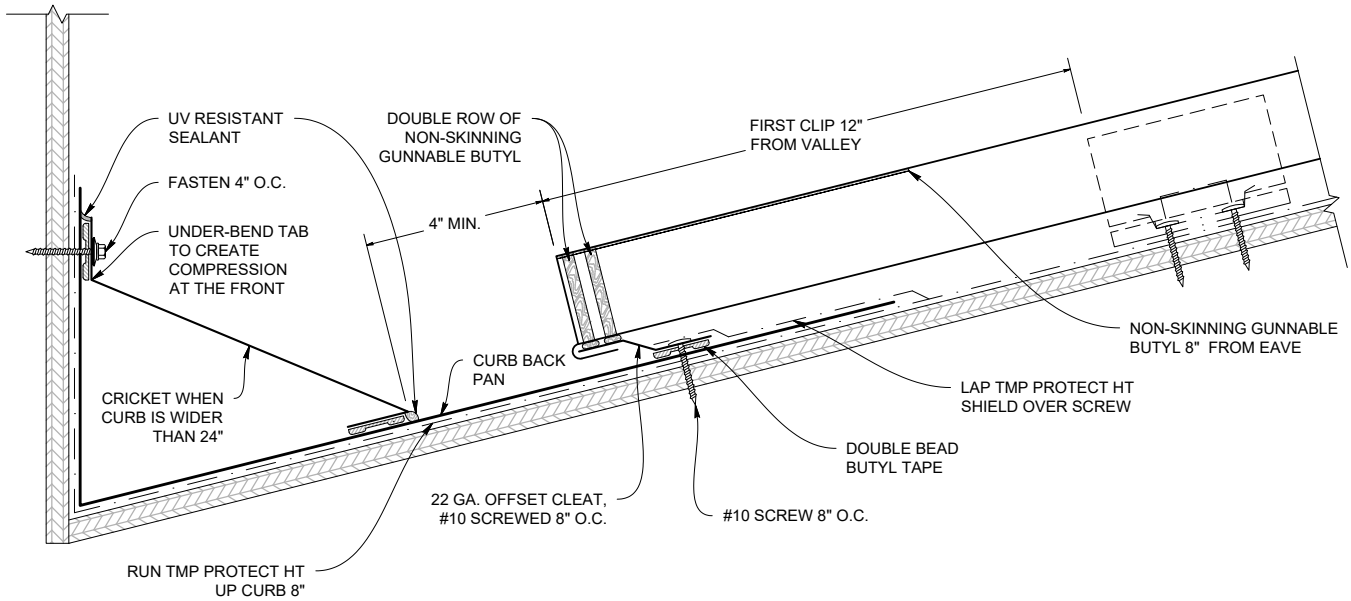

**CURB / PAN CRICKET DETAIL
(Less Than 3:12 Pitch)**

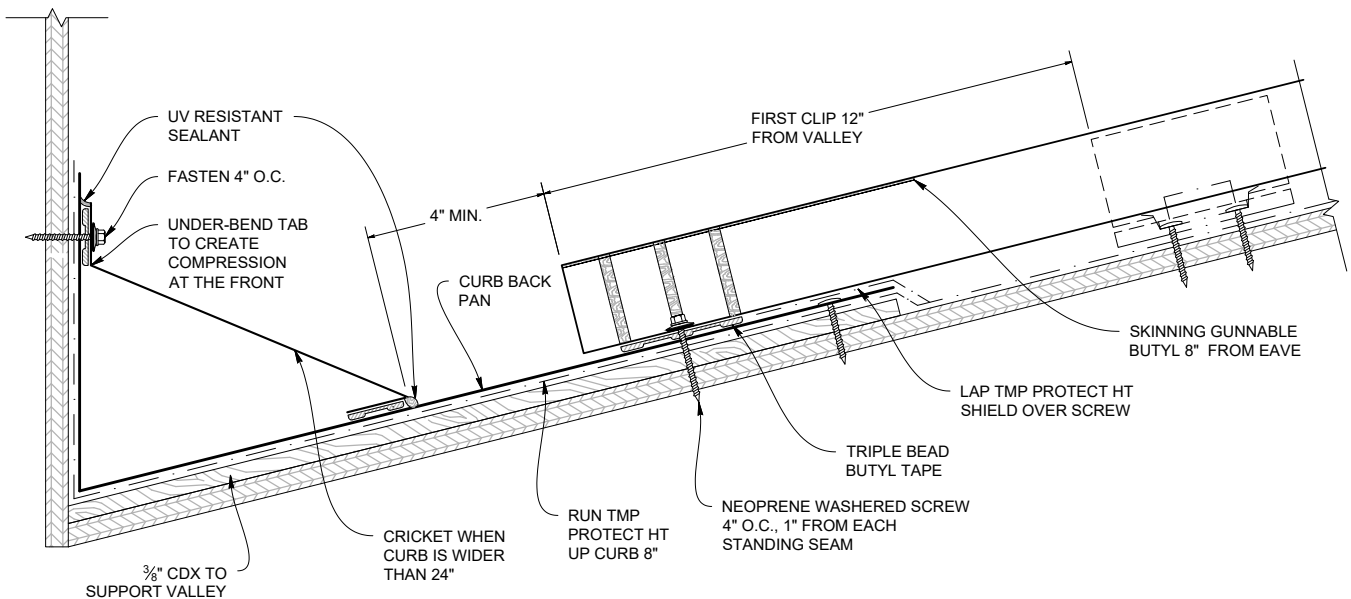

Note: All screws must be fastened into solid substrate.
Flashing must be lapped 4" with 3 rows of gunnable butyl.

EAVE TO GABLE TRANSITION

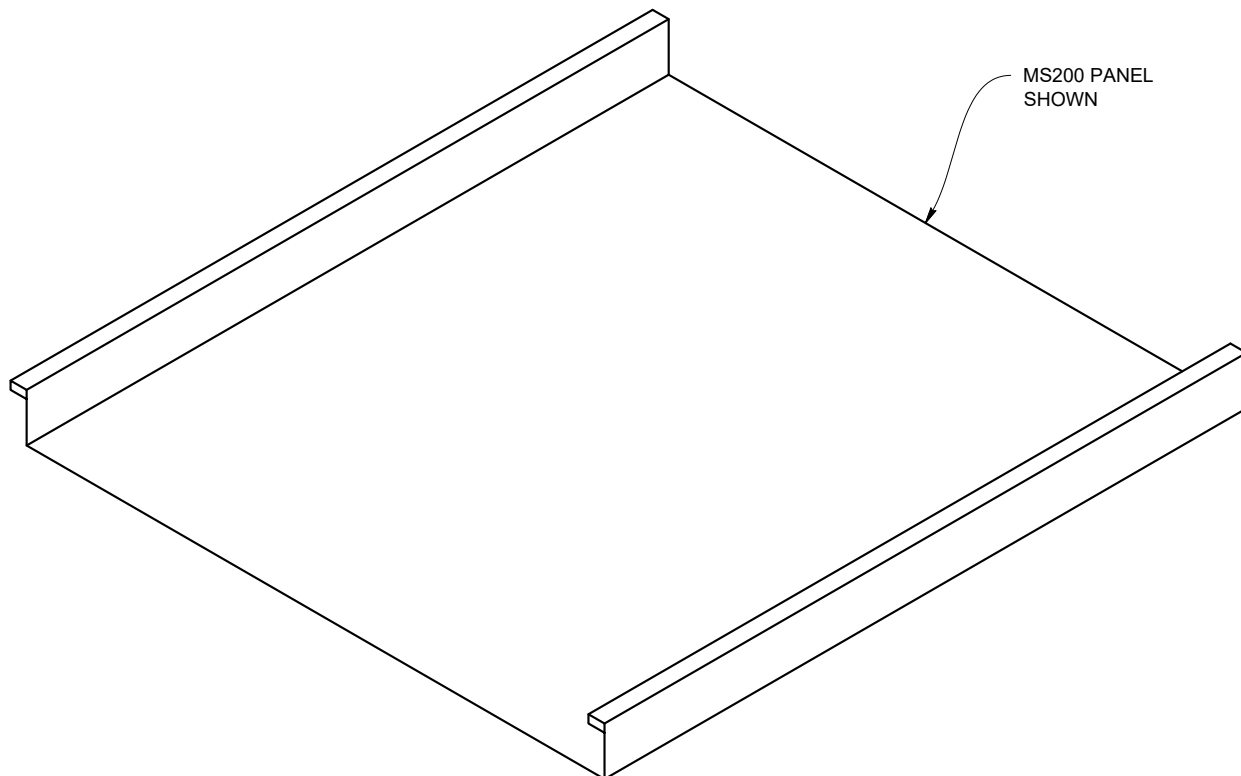

STEP 1

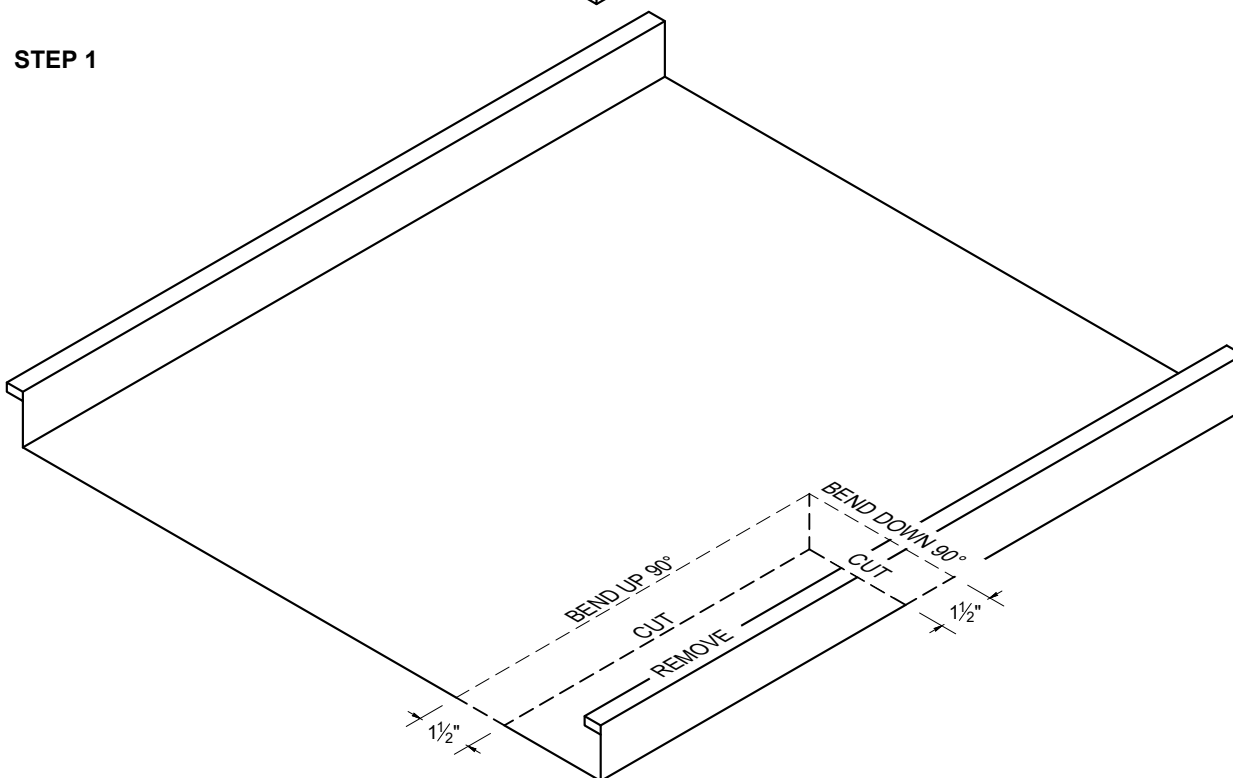

Note: All screws must be fastened into solid substrate.
Flashing must be lapped 4" with 3 rows of gunnable sealant.

Eave to Gable Transition

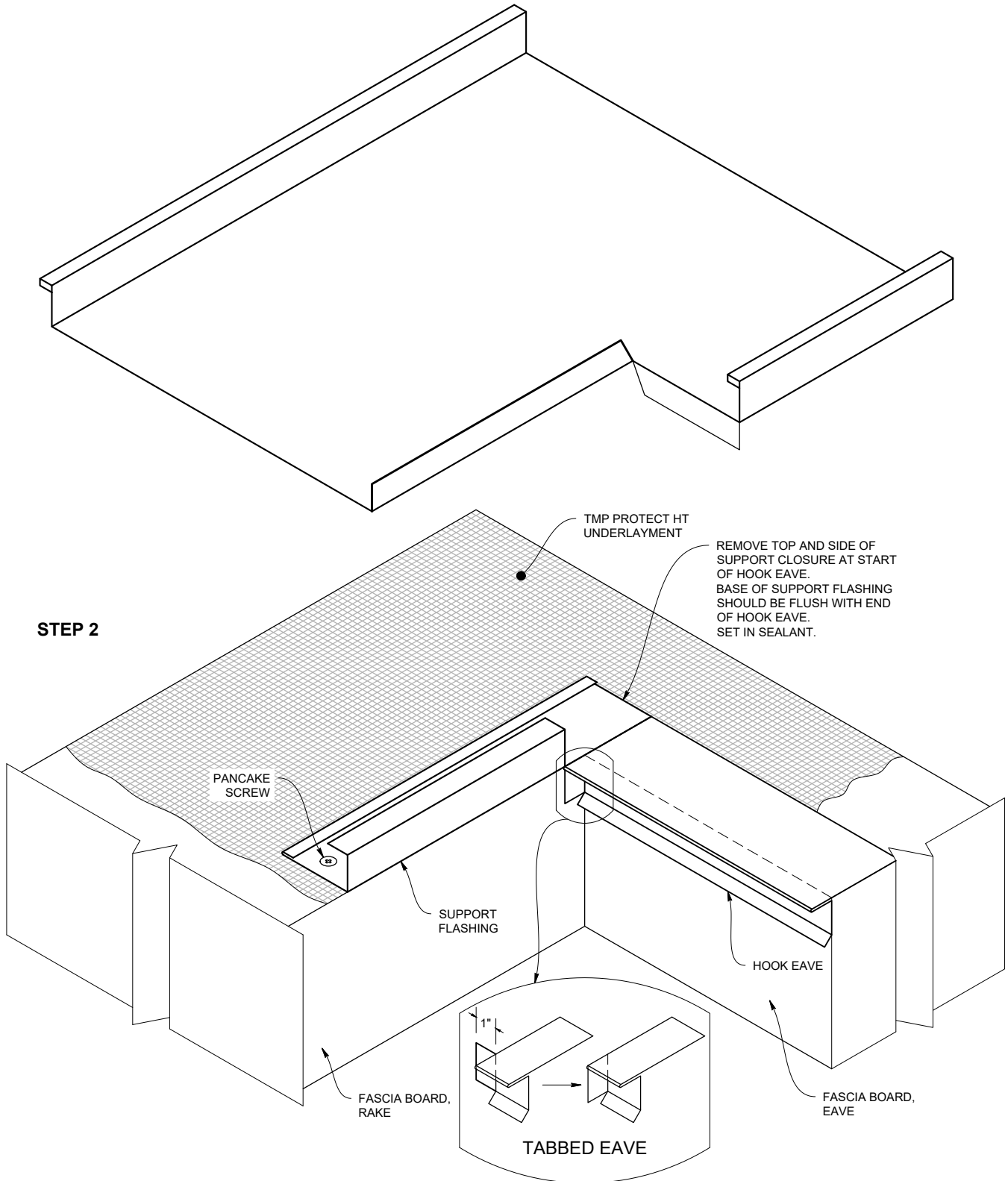

Note: All screws must be fastened into solid substrate.
Flashing must be lapped 4" with 3 rows of gunnable sealant.

STEP 3

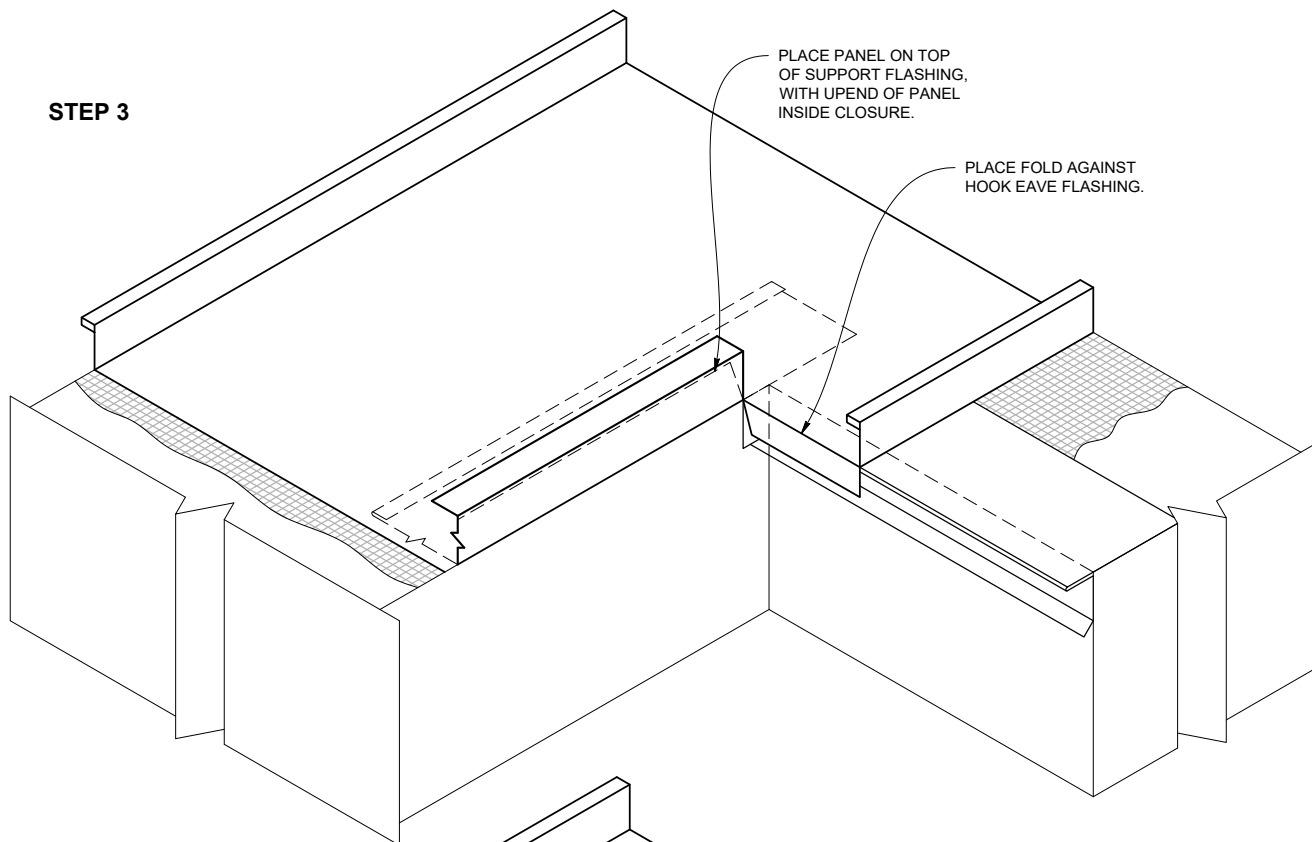

STEP 4

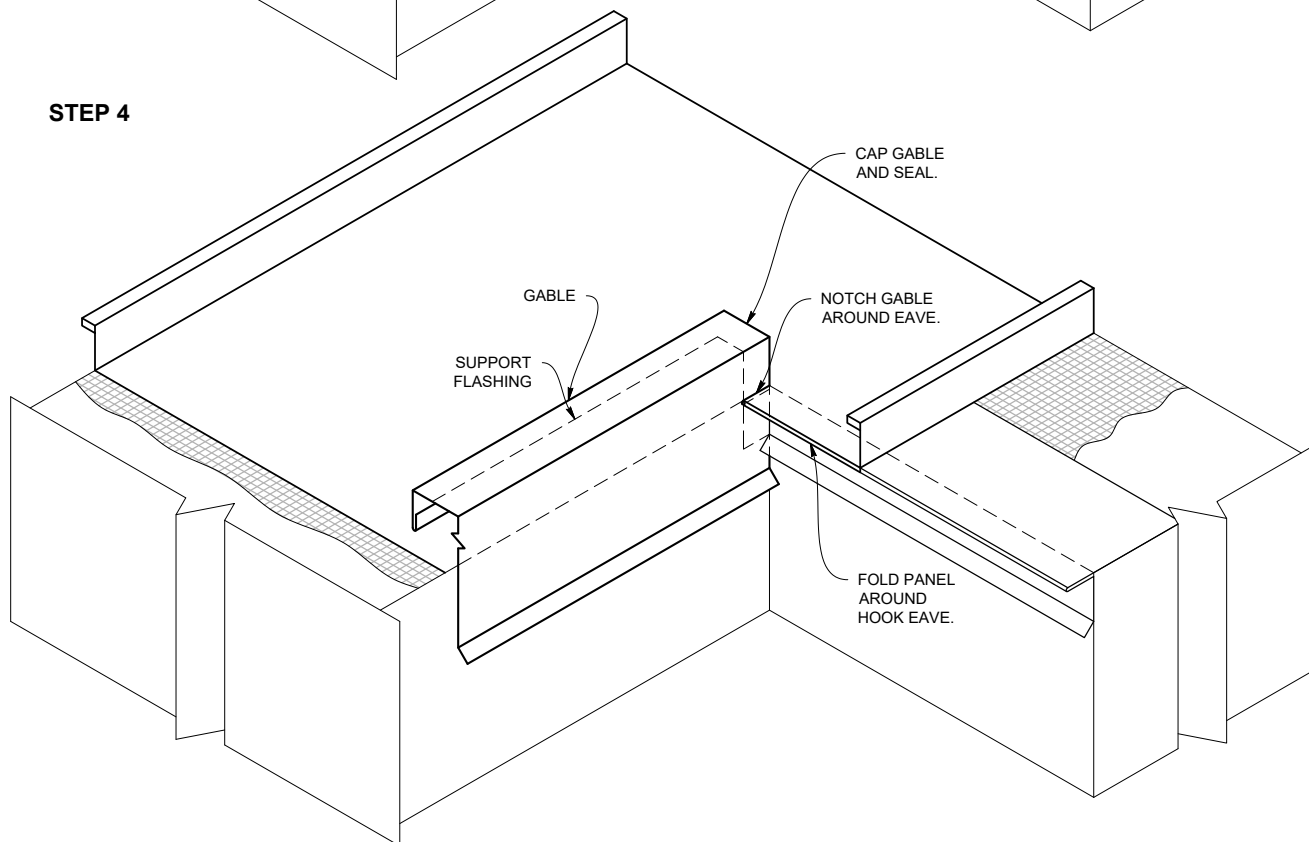

Note: All screws must be fastened into solid substrate.
Flashing must be lapped 4" with 3 rows of gunnable sealant.

Pipe Penetration - on Plate

FOR PIPES LOCATED 20' OR GREATER FROM PIN POINT
(Allows panel and pipe flashing to move with temperature change.)

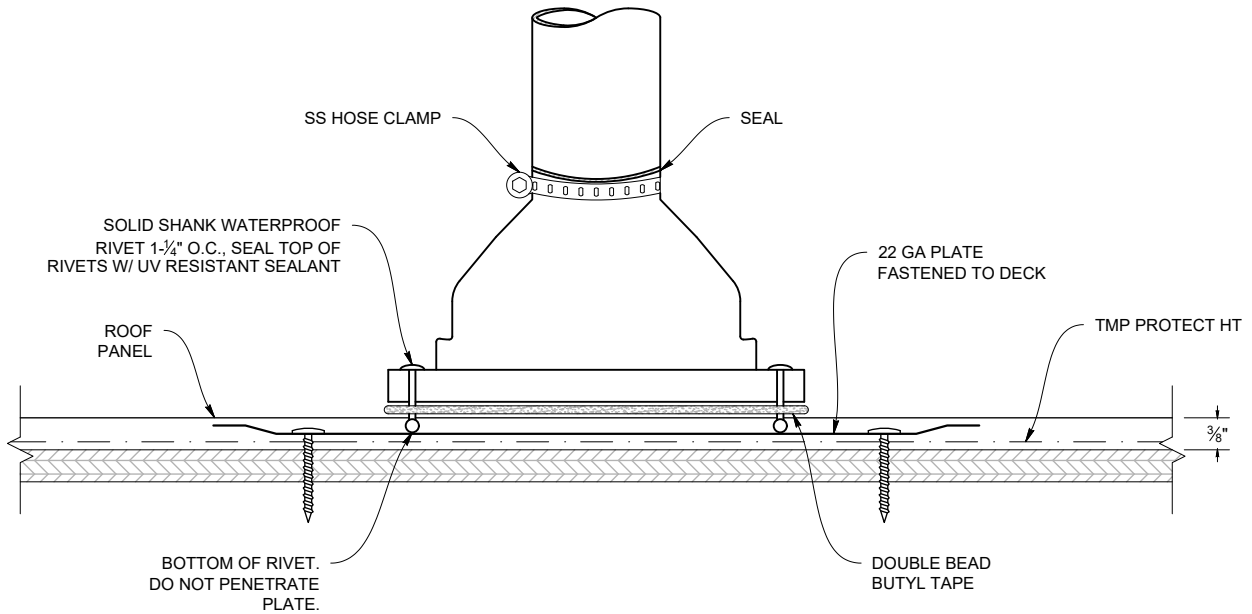

TWO TYPES OF PLATES YOU CAN USE:

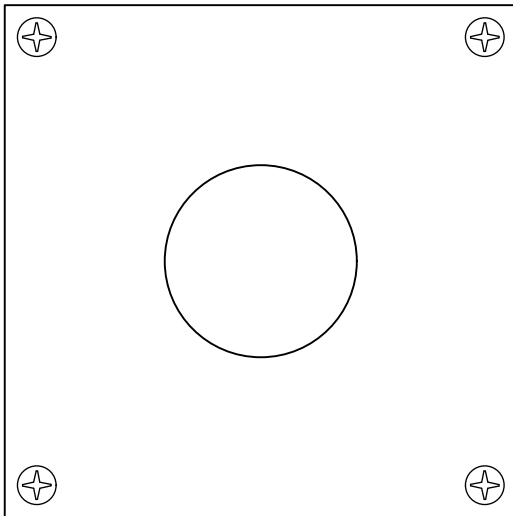

SINGLE PLATE

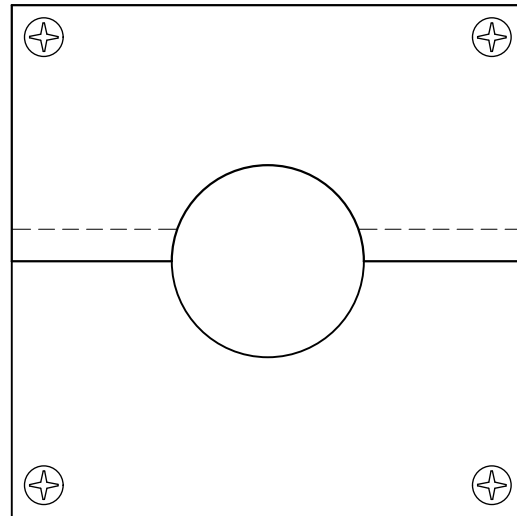

TWO HALF-PLATES

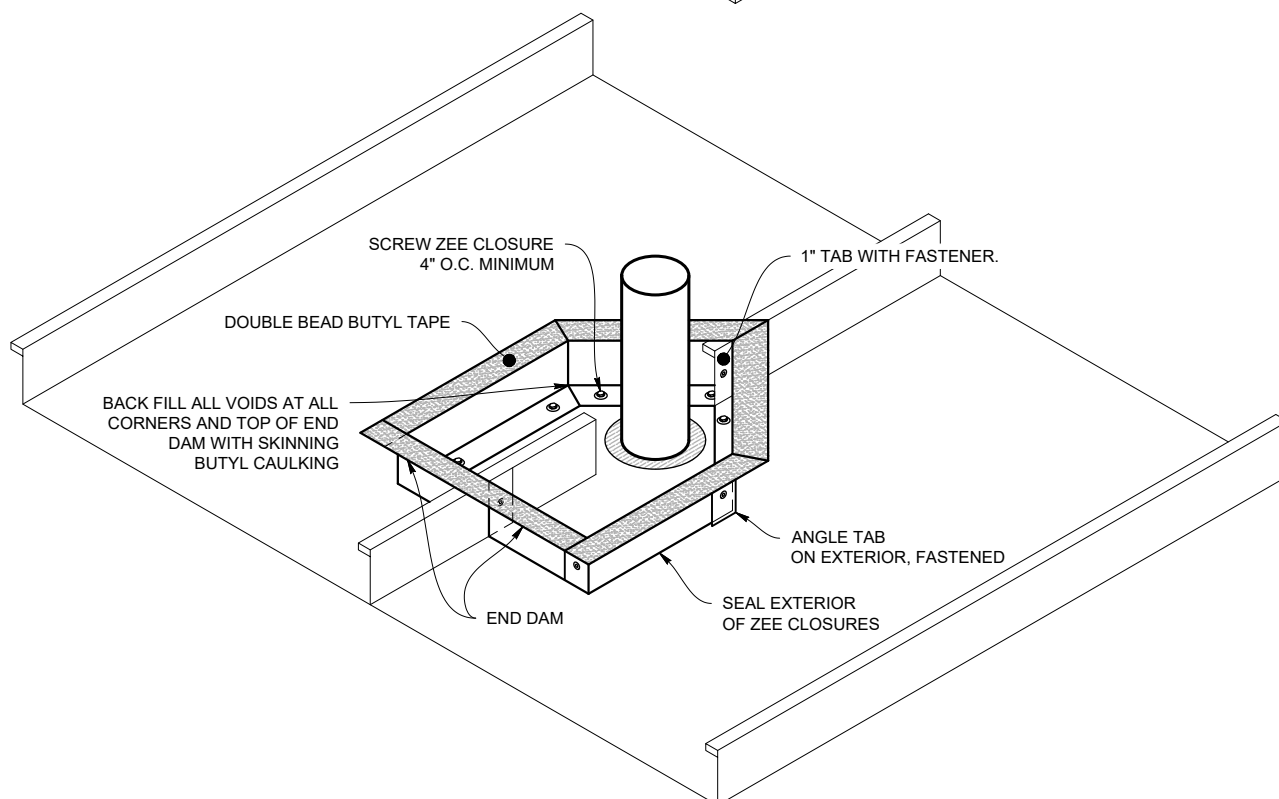
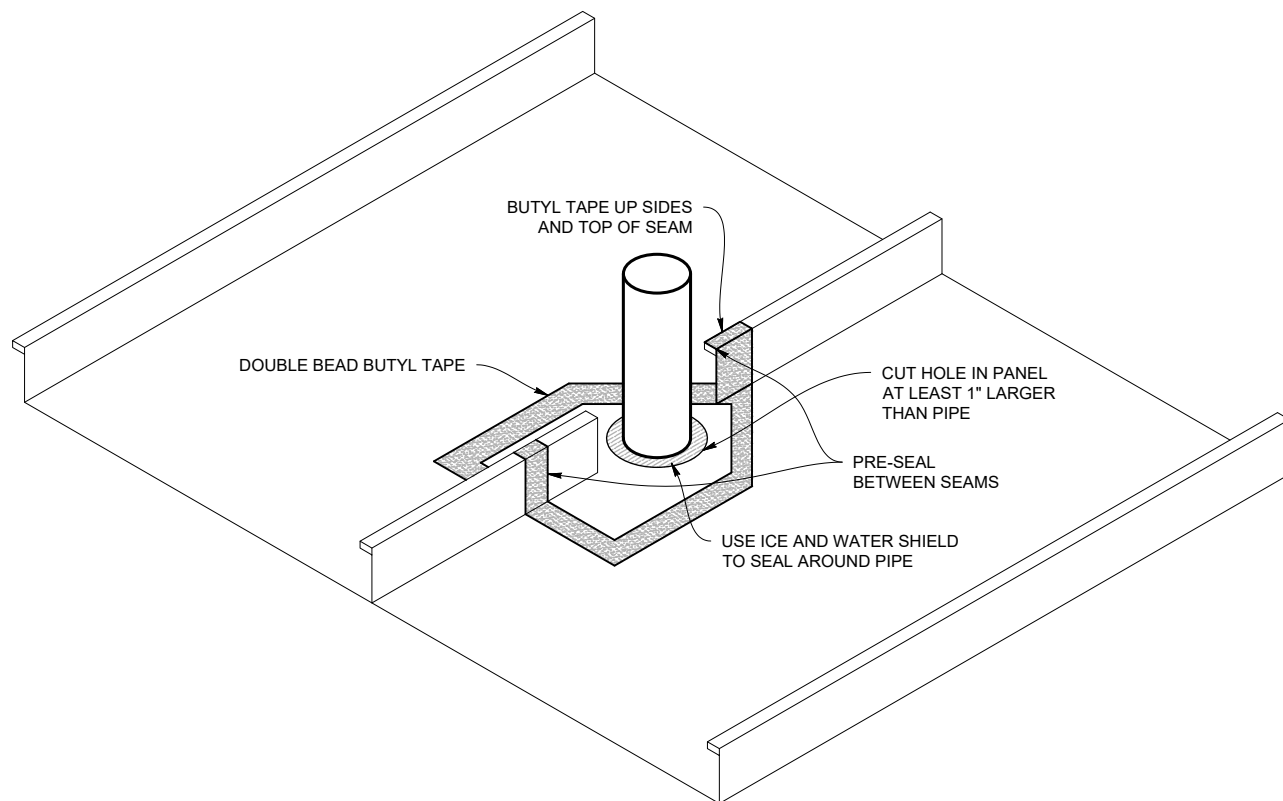

Note: All screws must be fastened into solid substrate.
Flashing must be lapped 4" with 3 rows of gunnable sealant.

Pipe Penetration - on Rib

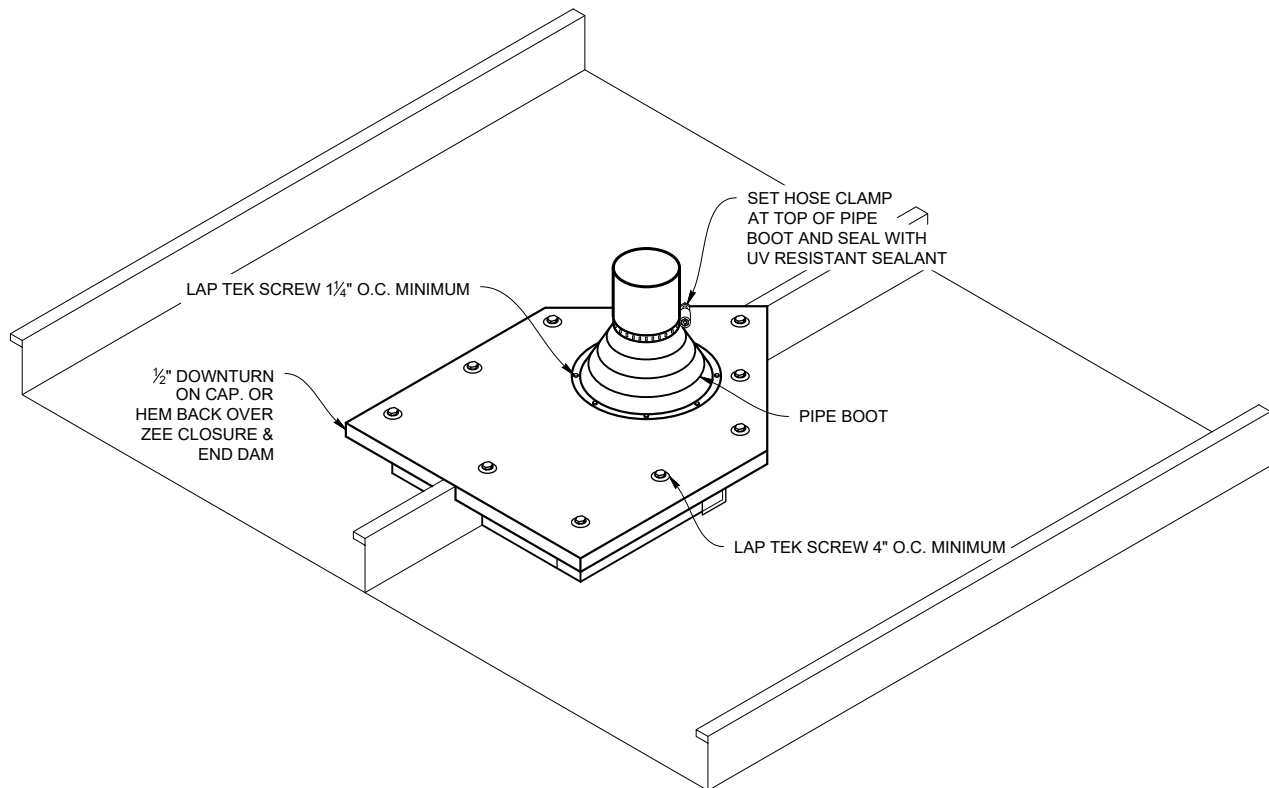
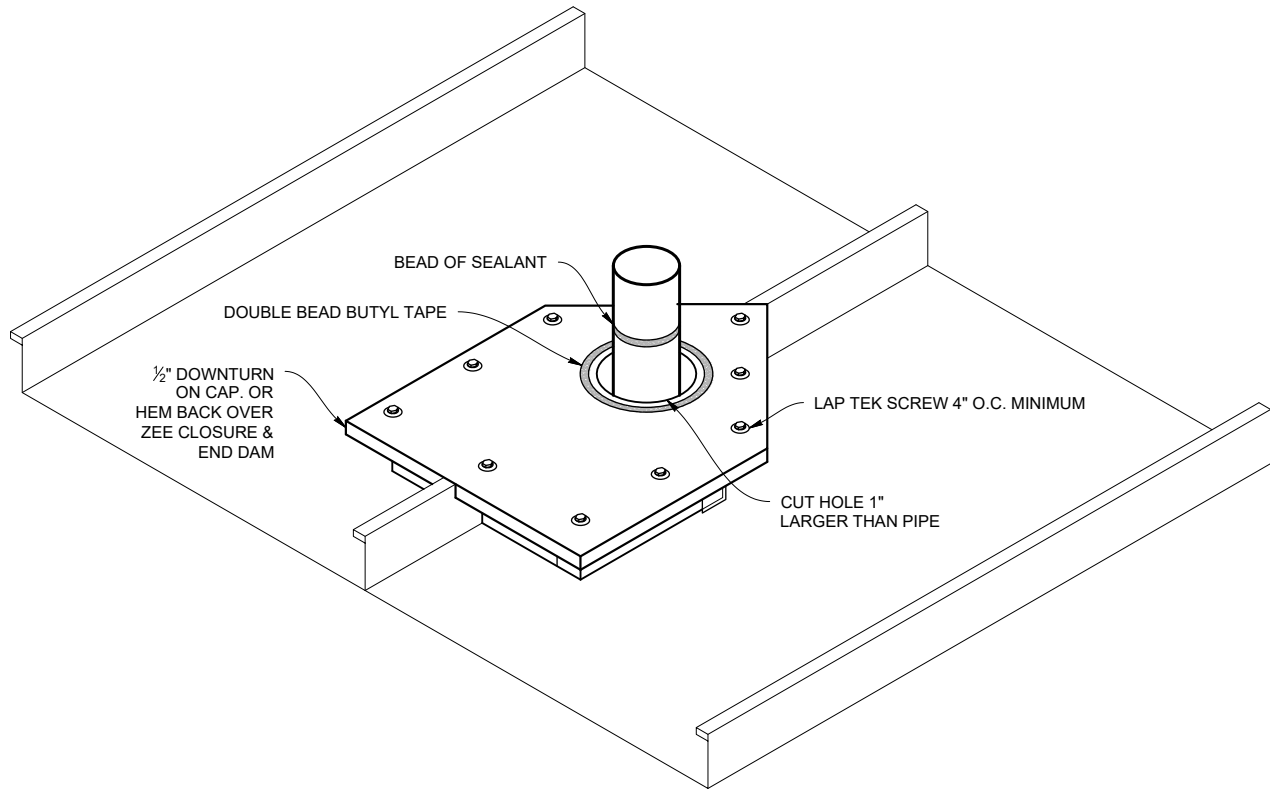

Note: All screws must be fastened into solid substrate.
Flashing must be lapped 4" with 3 rows of gunnable sealant.

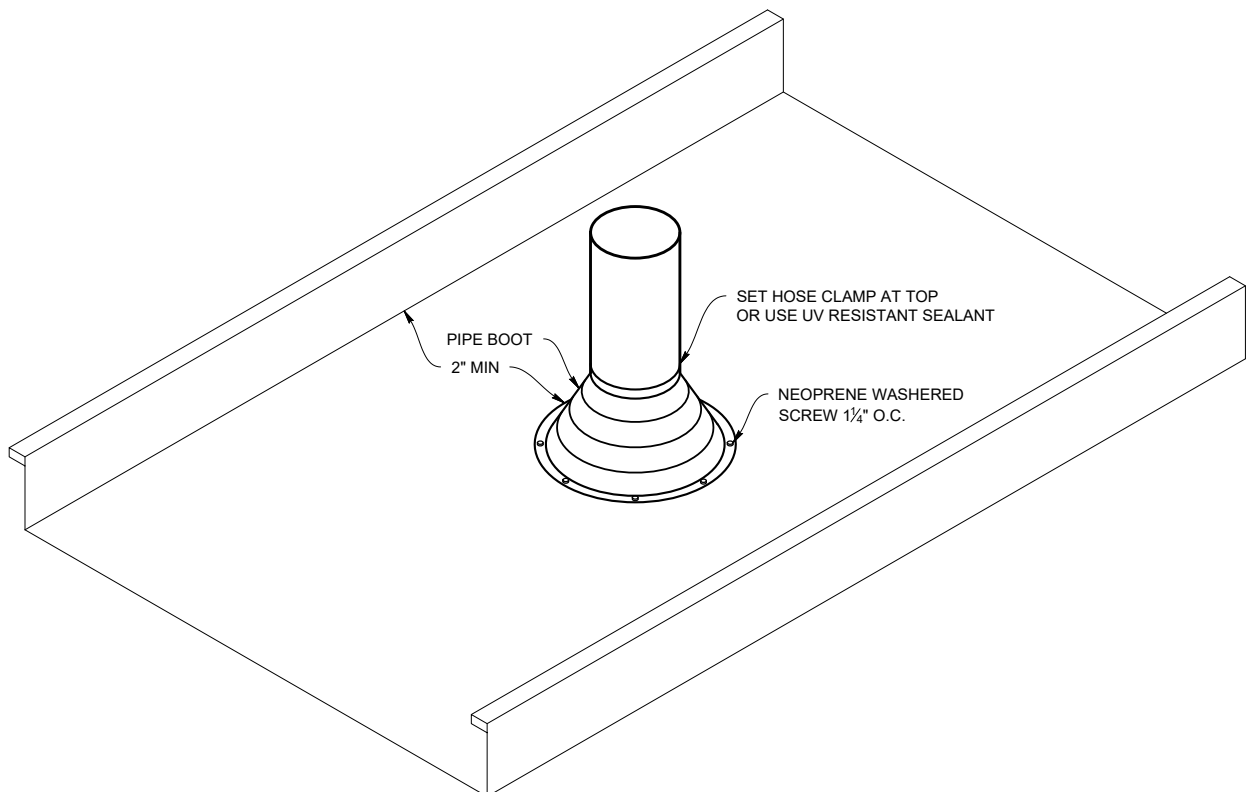
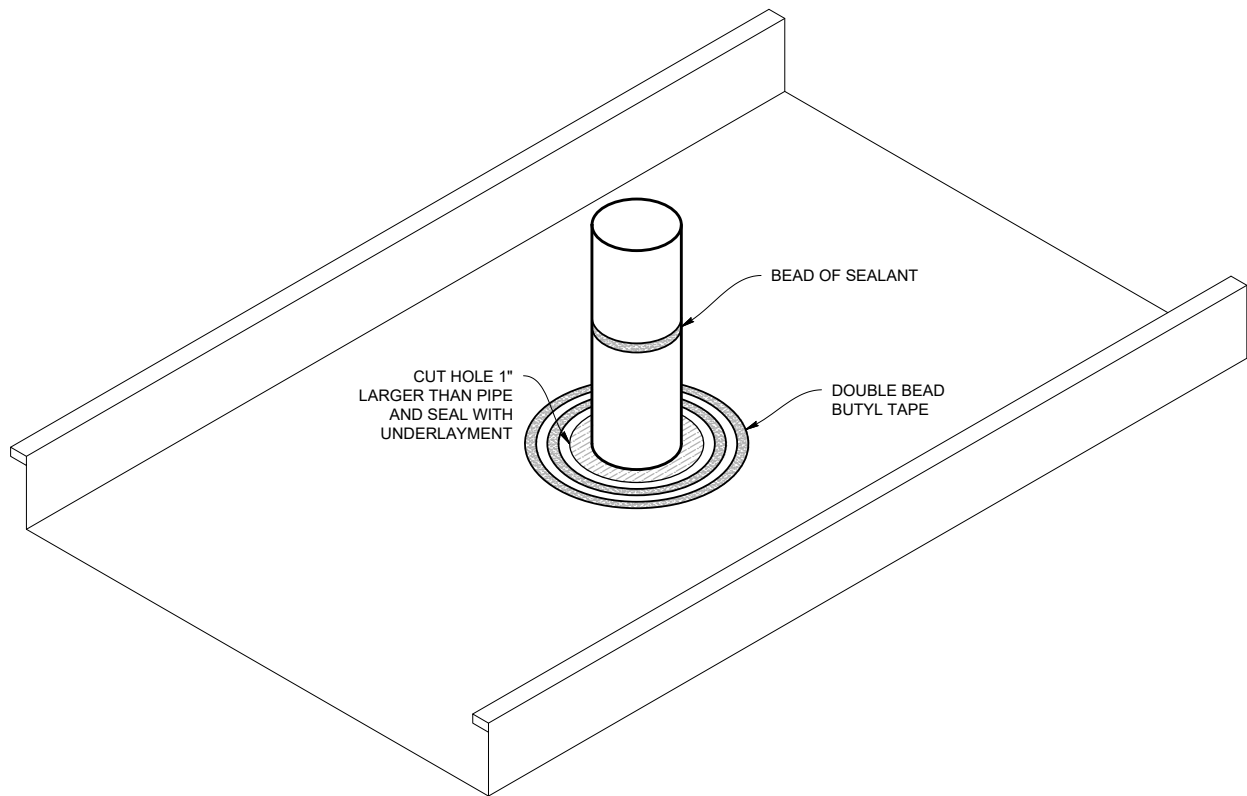

Note: All screws must be fastened into solid substrate.
Flashing must be lapped 4" with 3 rows of gunnable sealant.

<p>EAVE HOOK (MS200EH)</p> <p>SCALE 1:3 S.O. 8" WEIGHT: 6.5 LBS.</p>	<p>EAVE STANDARD (MS200ES)</p> <p>SCALE 1:3 S.O. 6" WEIGHT: 4.9 LBS.</p>	<p>ALT. EAVE (MS200EA)</p> <p>SCALE 1:3 S.O. 8.875" WEIGHT: 7.3 LBS.</p>
---	---	---

NON-VISIBLE / SUB-FLASHINGS ARE NOT PROVIDED IN SPECIFIC COLORS UNLESS SPECIFIED

<p>GABLE STANDARD (MS200GS)</p> <p>SCALE 1:4 S.O. 9.5" WEIGHT: 7.6 LBS.</p>	<p>GABLE SUPPORT CLEAT (MS200GC)</p> <p>SCALE 1:4 S.O. 5.75" WEIGHT: 4.7 LBS.</p>	<p>BOX GUTTER (MS200BG)</p> <p>SCALE 1:4 S.O. 16" WEIGHT: 13.3 LBS.</p>
--	--	--

<p>ALT. GABLE (MS200AT)</p> <p>SCALE 1:4 S.O. 8.5" WEIGHT: 7 LBS.</p>	<p>ALT. GABLE CLEAT (MS200AGC)</p> <p>SCALE 1:3 S.O. 8.625" WEIGHT: 7.02 LBS.</p>	<p>SUPPORT FLASHING (MS200FMSF)</p> <p>SCALE 1:3 S.O. 8.25" WEIGHT: 6.71 LBS.</p>
--	--	--

STANDARD RIDGE
(MS200RS)

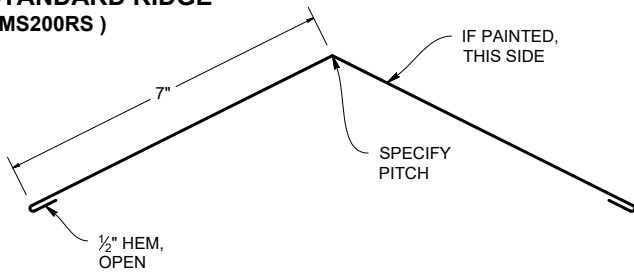

SCALE 1:4 S.O. 15" WEIGHT: 12.2 LBS.

VALLEY FLASHING
(MS200VF)

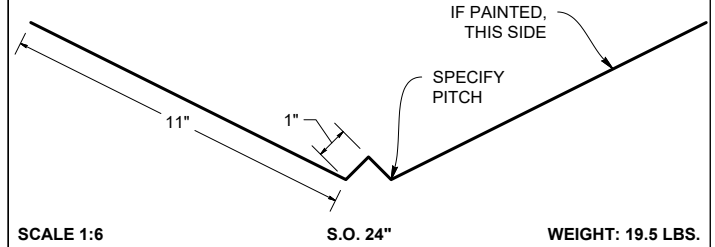

SCALE 1:6 S.O. 24" WEIGHT: 19.5 LBS.

RIDGE FULL VENTED
(MS200RFV)

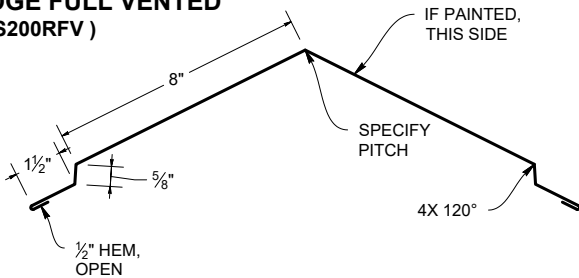

SCALE 1:6 S.O. 21.25" WEIGHT: 17.3 LBS.

WT RIDGE FULL VENTED
(MS200WTRFV)

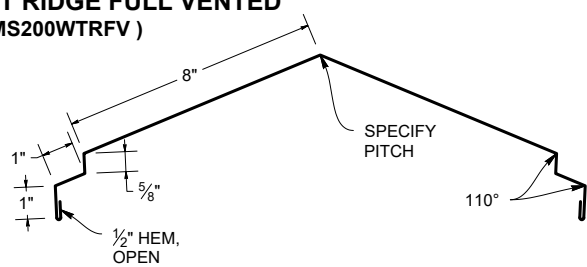

SCALE 1:6 S.O. 22.25" WEIGHT: 18.1 LBS.

PERFORATED STRIP
(MS200PS)

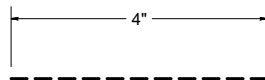

SCALE 1:3 S.O. 4" WEIGHT: 3.3 LBS.

PERFORATED VENT DRIP
(MS200PVD)

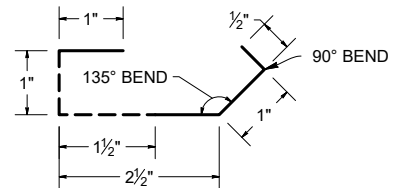

SCALE 1:3 S.O. 6" WEIGHT: 4.9 LBS.

PEAK FLASHING (R.E.C.)
(MS200REC)

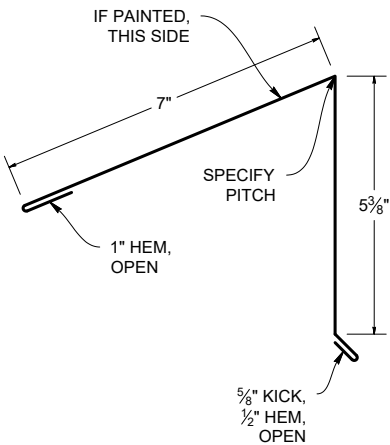

SCALE 1:4 S.O. 14.5" WEIGHT: 12.0 LBS.

VENTED PEAK FLASHING
(MS200RECV)

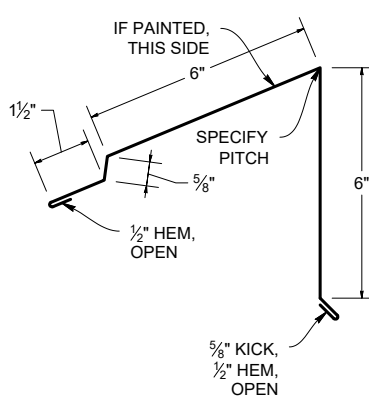

SCALE 1:5 S.O. 15.75" WEIGHT: 13.0 LBS.

WT VENTED PEAK FLASHING
(MS200WTRECV)

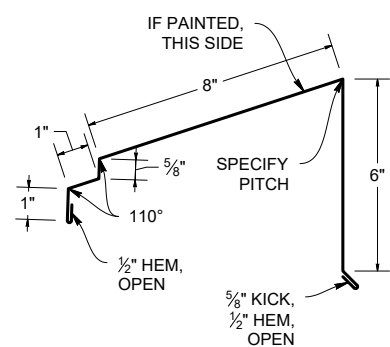

SCALE 1:6 S.O. 18.25" WEIGHT: 7.0 LBS.

<p>PEAK CLEAT (MS200RECC)</p> <p>1" SPECIFY PITCH 5 1/4" 1/2" KICK AT 135°</p> <p>SCALE 1:3 S.O. 6.75" WEIGHT: 5.5 LBS.</p>	<p>VENTED PEAK CLEAT (MS200VRECC)</p> <p>1" 5 7/8" 1/2" KICK AT 135°</p> <p>SCALE 1:3 S.O. 7.375" WEIGHT: 6.0 LBS.</p>	<p>ENDWALL (MS200EW)</p> <p>IF PAINTED, THIS SIDE 5" SPECIFY PITCH 6" 1/2" HEM, OPEN</p> <p>SCALE 1:5 S.O. 11.5" WEIGHT: 9.8 LBS.</p>
<p>VENTED ENDWALL (MS200EWW)</p> <p>IF PAINTED, THIS SIDE SPECIFY PITCH 4 3/8" 5" 1/2" 5/8" 2X 135° 1/2" HEM, OPEN</p> <p>SCALE 1:5 S.O. 12" WEIGHT: 9.8 LBS.</p>	<p>WT VENTED ENDWALL (MS200WTEVV)</p> <p>4 3/8" SPECIFY PITCH 8" 1" 1/2" 5/8" 110° 1/2" HEM</p> <p>SCALE 1:5 S.O. 15.5" WEIGHT: 12.6 LBS.</p>	<p>SIDEWALL (MS200SW)</p> <p>IF PAINTED, THIS SIDE 4 1/4" 1 3/4" 1/2" HEM, OPEN</p> <p>SCALE 1:3 S.O. 8.25" WEIGHT: 6.7 LBS.</p>
<p>CURB SIDEWALL (MS200CSW)</p> <p>IF PAINTED, THIS SIDE 4" 1 3/4" 1/2" HEM, OPEN 4"</p> <p>SCALE 1:5 S.O. 10.25" WEIGHT: 8.3 LBS.</p>	<p>CURB ENDWALL (MS200CH)</p> <p>IF PAINTED, THIS SIDE 5" 6" 1/2" HEM, OPEN</p> <p>SCALE 1:5 S.O. 11.5" WEIGHT: 9.8 LBS.</p>	<p>OFFSET CLEAT (MS200FMOC)</p> <p>150° 1" 1/4" 3/8" 3/4"</p> <p>SCALE 1:2 S.O. 3" WEIGHT: 2.5 LBS.</p>

BACK PAN
(MS200PAN)

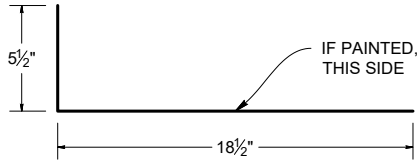

SCALE 1:10 S.O. 24" WEIGHT: 19.5 LBS.

ZEE CLOSURE
(MS200ZC)

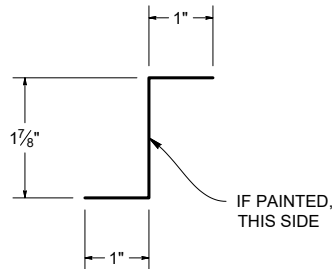

SCALE 1:3 S.O. 3.875" WEIGHT: 3 LBS.

REGLET
(MS200RF)

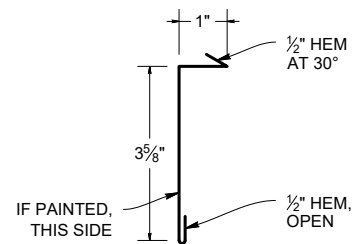

SCALE 1:4 S.O. 5.625" WEIGHT: 4.6 LBS.

END DAM

END DAM IS EXAMPLE ONLY SEE
SPECIFIC END DAM DETAIL
SHEET FOR DIMENSIONS
(SEPARATE FORM)

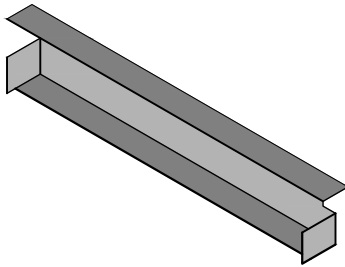

SCALE 1:10 S.O. VARIES WEIGHT: VARIES

Customer Name: _____ Job Name: _____

Gauge: _____ Color: _____ Status: Original New

Specify: Angles Color Side Dimensions Stretchout

SO _____

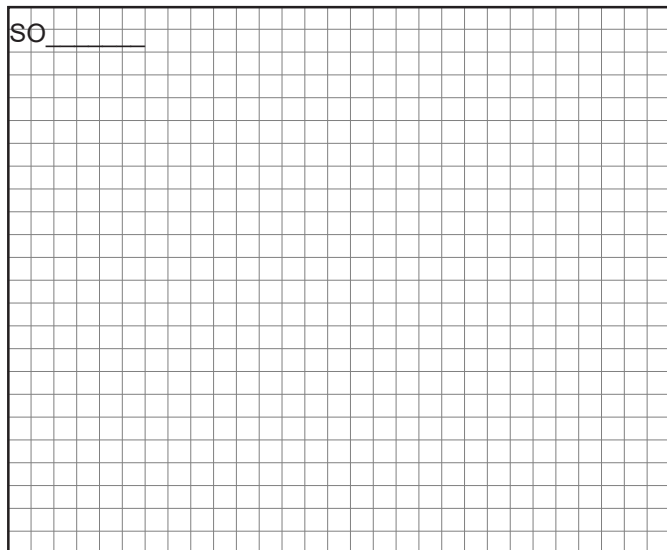

Dwg #: _____ Pitch: _____ # of Pieces: _____

Description: _____

Hems: Open Closed Slightly Open

SO _____

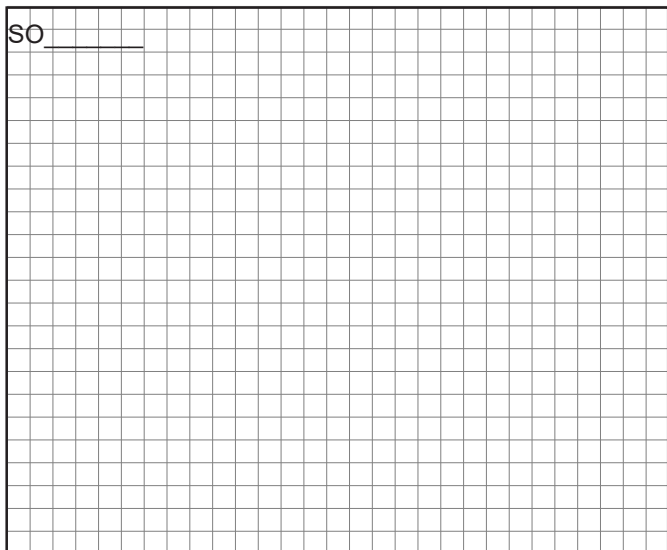

Dwg #: _____ Pitch: _____ # of Pieces: _____

Description: _____

Hems: Open Closed Slightly Open

SO _____

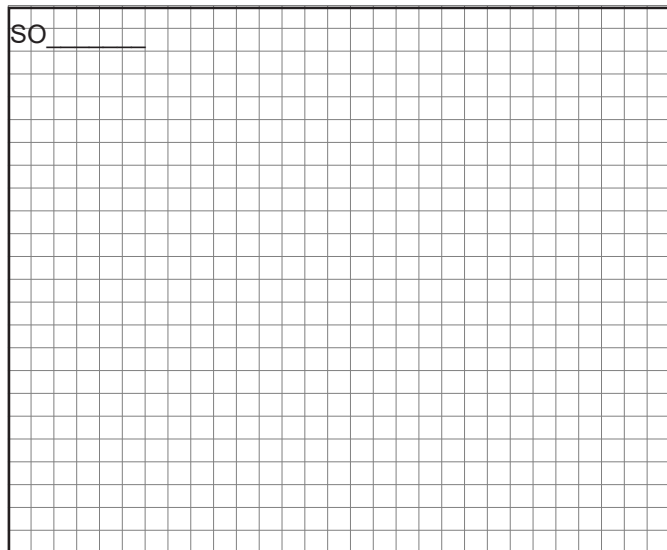

Dwg #: _____ Pitch: _____ # of Pieces: _____

Description: _____

Hems: Open Closed Slightly Open

SO _____

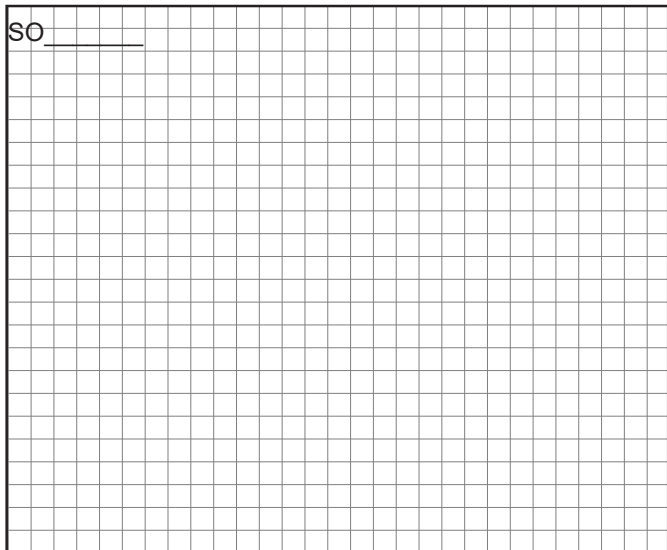

Dwg #: _____ Pitch: _____ # of Pieces: _____

Description: _____

Hems: Open Closed Slightly Open

Please provide a drawing for each flashing with precise measurements and angles
Fax to: 503-581-6877

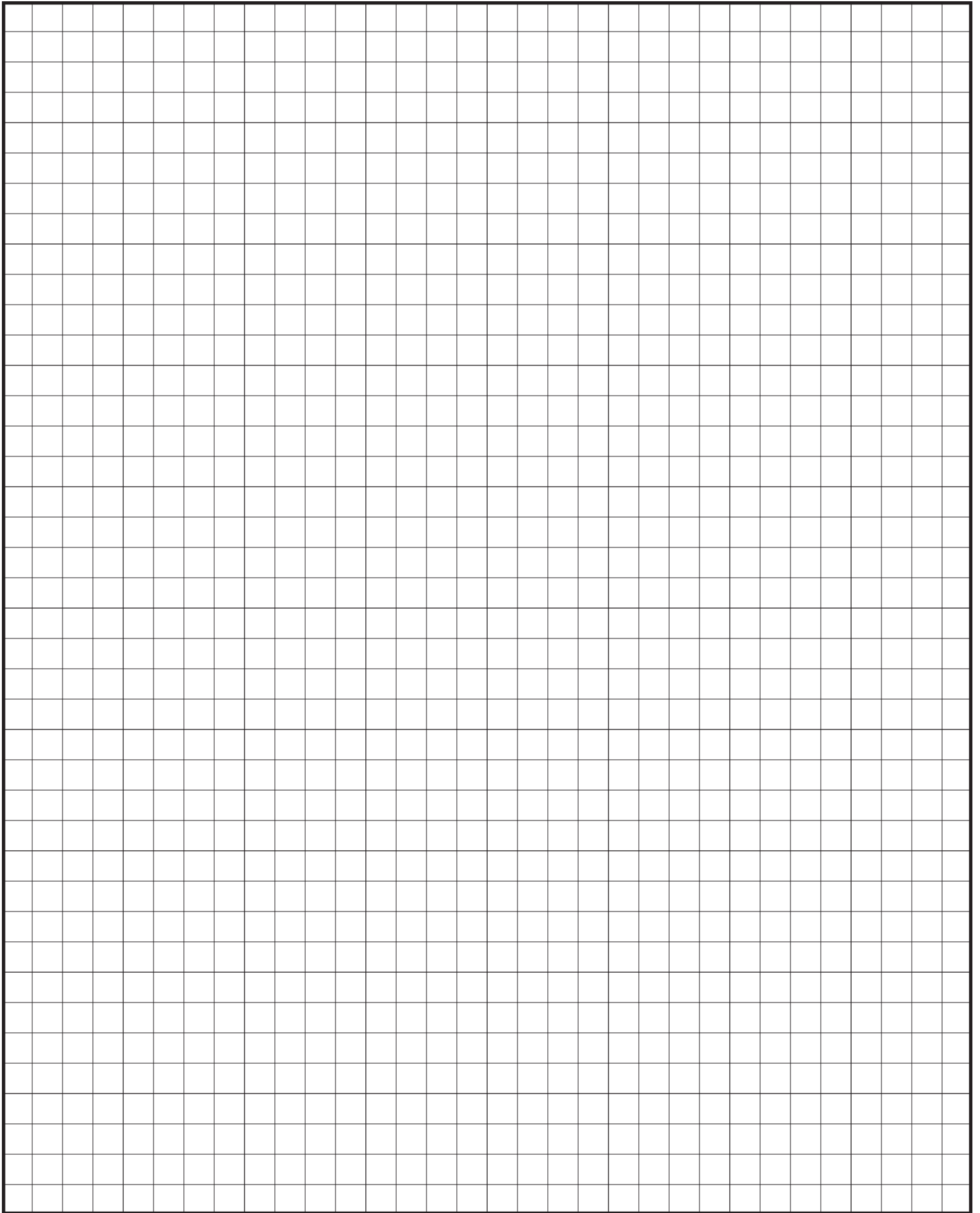

Customer Name: _____ Job Name: _____

Gauge: _____ Color: _____ Status: Original New

Specify: Angles Color Side Dimensions Stretchout

SO _____

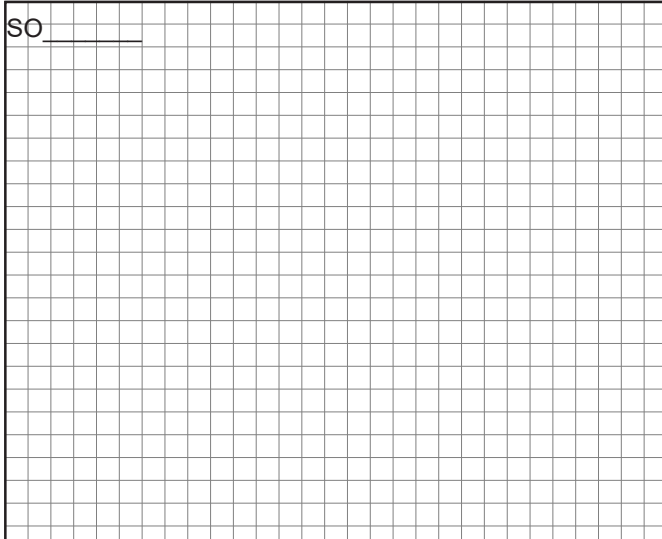

Dwg #: _____ Pitch: _____ # of Pieces: _____

Description: _____

Hems: Open Closed Slightly Open

SO _____

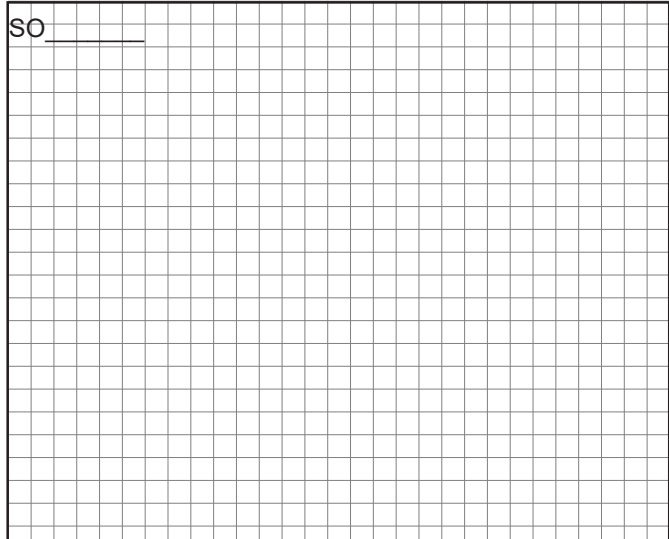

Dwg #: _____ Pitch: _____ # of Pieces: _____

Description: _____

Hems: Open Closed Slightly Open

SO _____

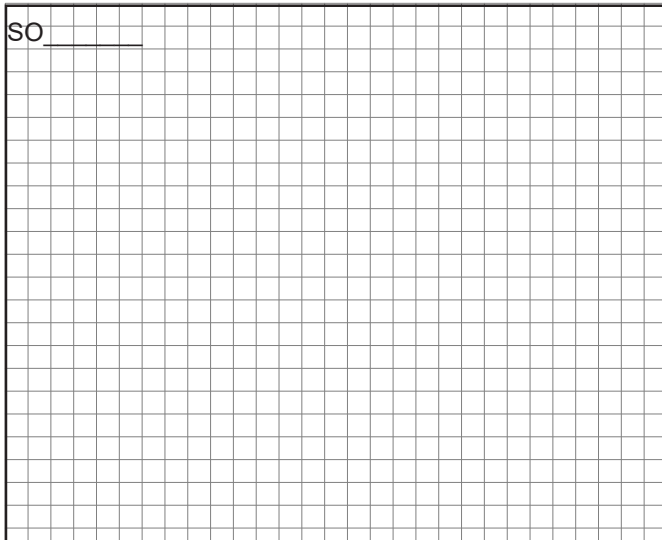

Dwg #: _____ Pitch: _____ # of Pieces: _____

Description: _____

Hems: Open Closed Slightly Open

SO _____

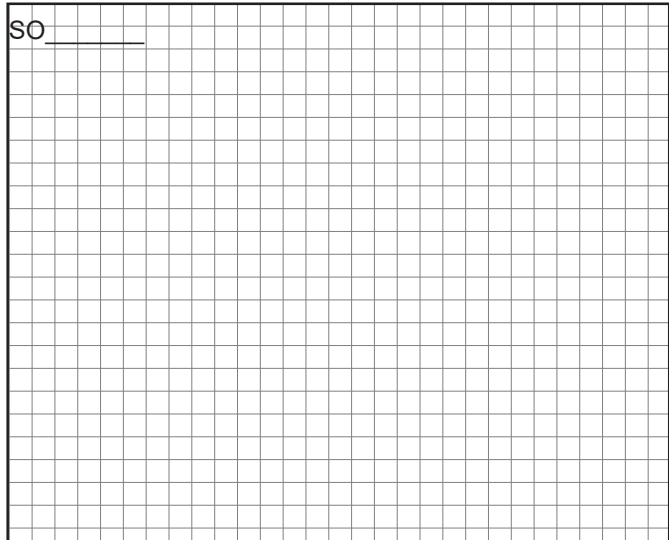

Dwg #: _____ Pitch: _____ # of Pieces: _____

Description: _____

Hems: Open Closed Slightly Open

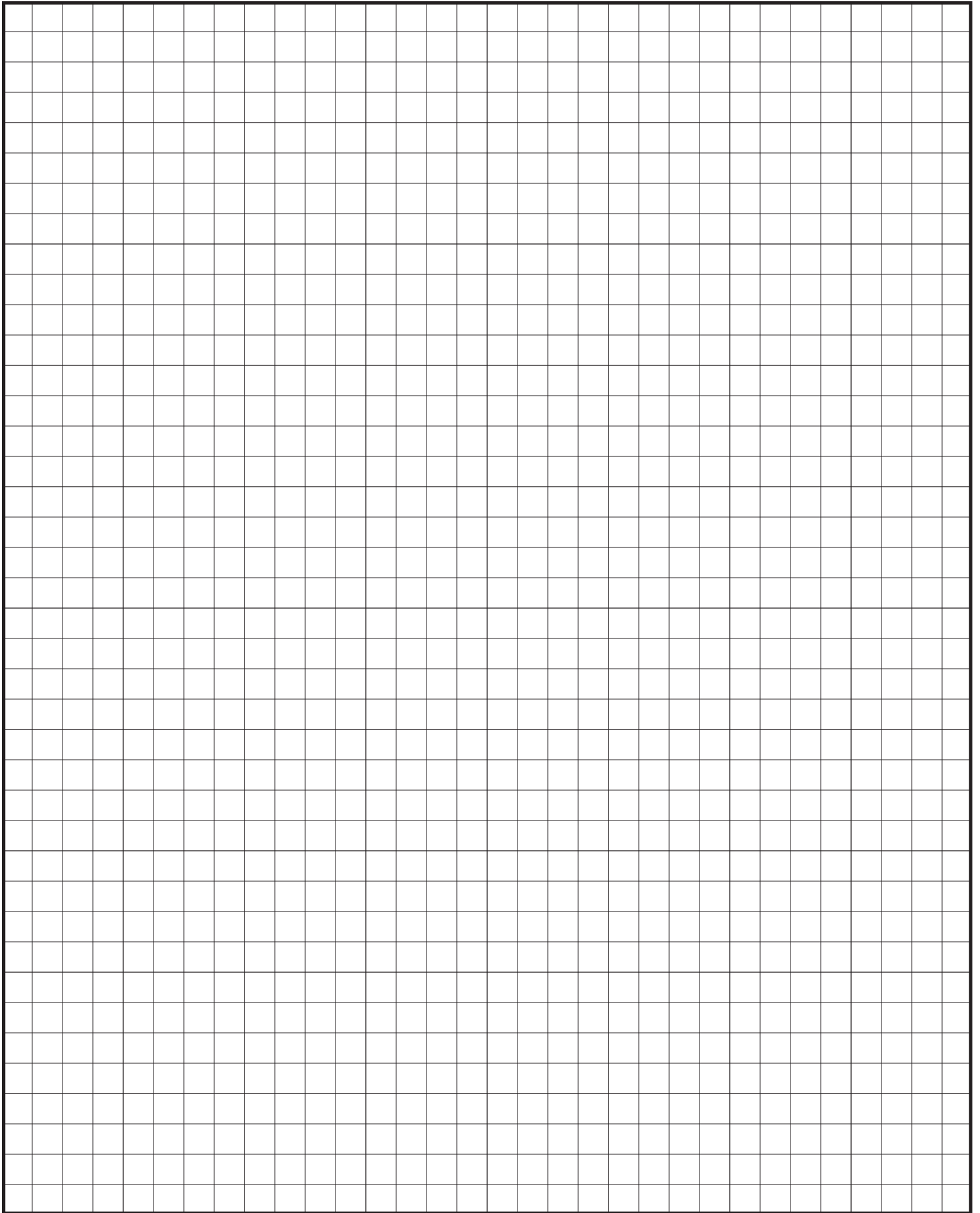



TAYLOR

METAL PRODUCTS

QUALITY PRODUCTS
EXCEPTIONAL SERVICE

SALEM BRANCH

4566 Ridge Dr. NE
Salem, OR 97301

Office: 503-581-8338
Toll Free: 1-800-574-1388
Fax: 503-581-6877

SACRAMENTO BRANCH

3443 Airport Rd,
Sacramento, CA 95834

Office: 916-318-8844
Toll Free: 1-800-574-1388
Fax: 916-993-4123

SPOKANE BRANCH

1010 N Nelson St.,
Spokane, WA 99202
www.go-rsp.com

Office: 509-535-8667
Toll Free: 800-238-4057
Fax: 509-535-8682

AUBURN BRANCH

2601 C St SW,
Auburn, WA 98001

Office: 206-900-9923
Toll Free: 1-800-574-1388
Fax: 253-804-3545

RIVERSIDE BRANCH

4880 Felspar St.
Riverside, CA 92509

Office: 323-407-7457
Toll Free: 1-877-504-1594